

TOTO



H0B509C
2024.7

(This code is for manufacturer management use.)

Installation Guide

NEOREST NX

CS902 Series

Required	...	P.2
Safety Cautions	...	P.6
Precautions before installation	...	P.8
Included Parts	...	P.9
Required items	...	P.9
Part diagram	...	P.10
Installation procedure	...	P.11
Trial run	...	P.28

Required

Use the protective sheet when installing the toilet bowl.

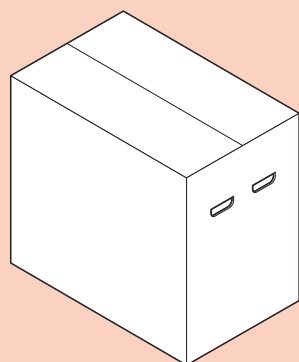

1

2

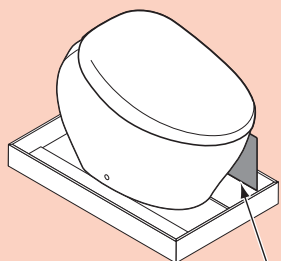
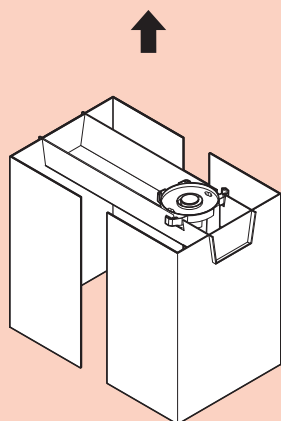

H-3 (protective sheet)

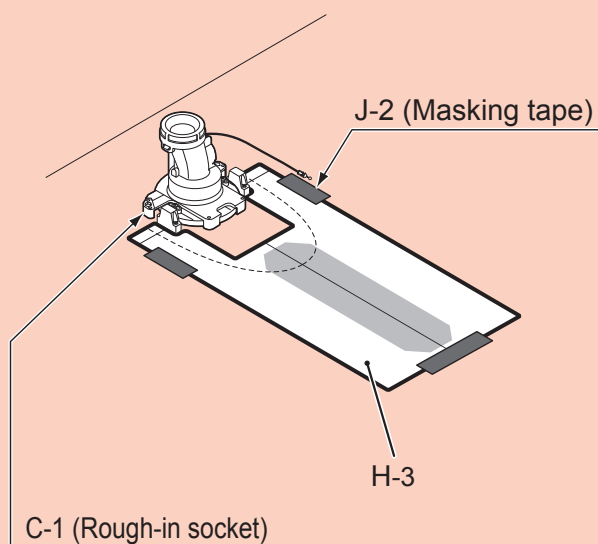

J-2 (Masking tape)

H-3

C-1 (Rough-in socket)



* Refer to "Installation procedure 9 to 19 " on pages 14 and 16 for details.

3

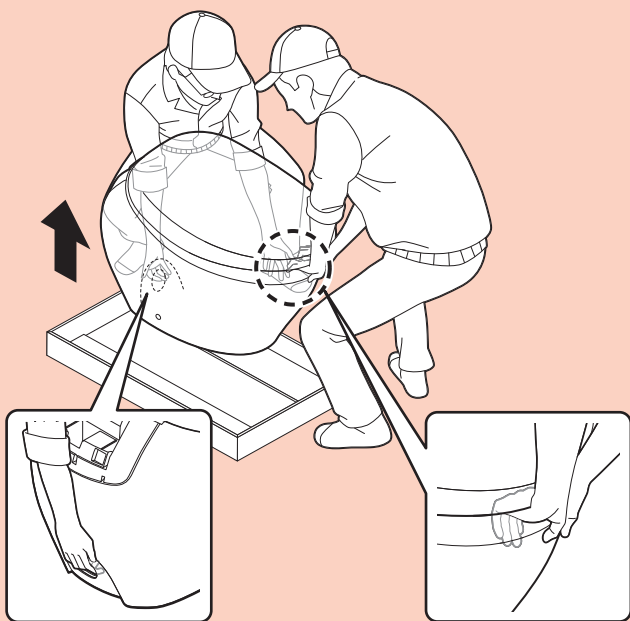

Or

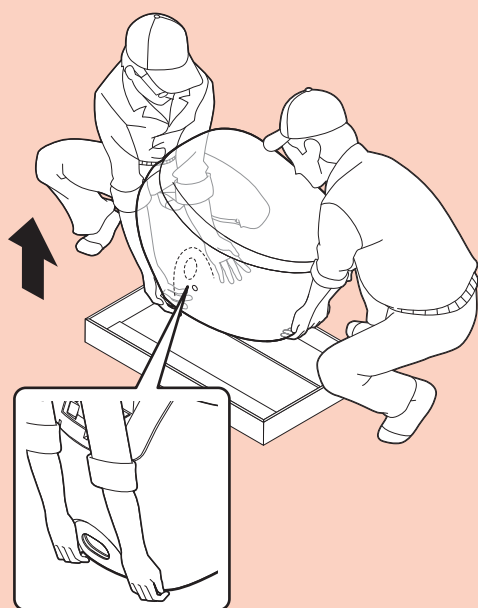
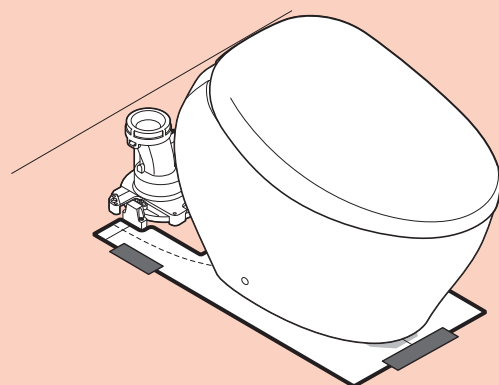

Required

Install the rough-in socket wire to the manual lever.

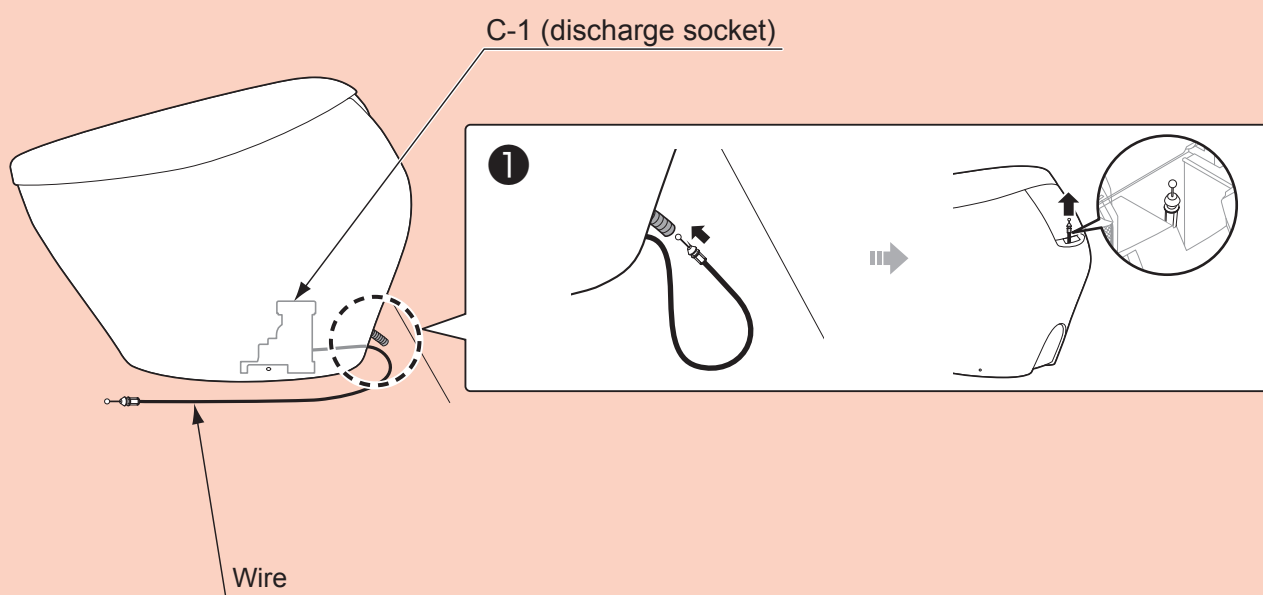

* Refer to "Installation procedure 22 to 26 " on pages 18 and 23 for details.

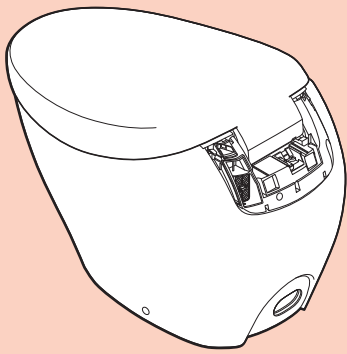

2

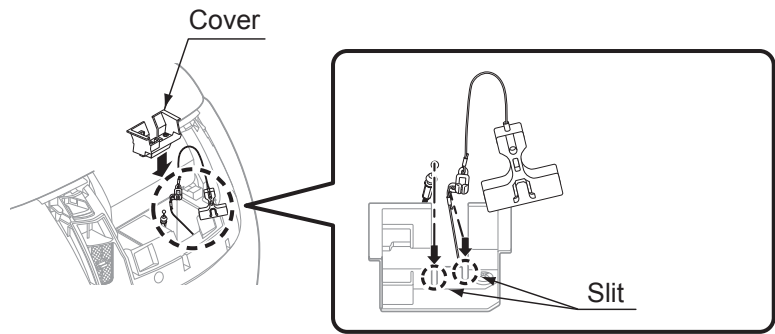

3

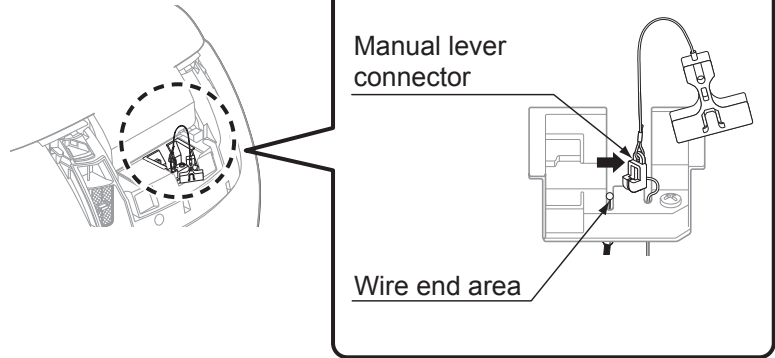

4

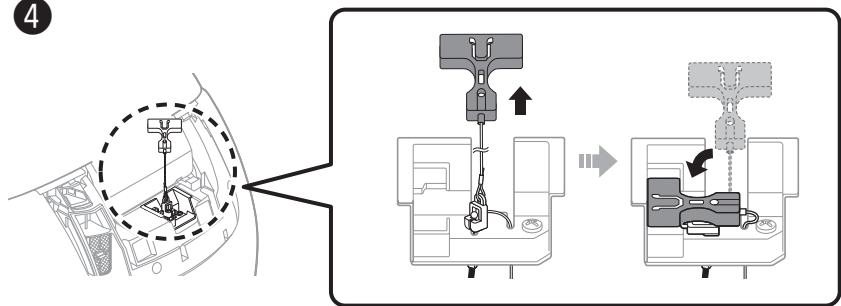

For installers

Seat sensor (built-in)

- A label is attached on the seat sensor area.
(It shows the customer where the seat sensor is.)

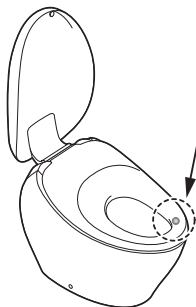

→ Refer to **Remote control mounting**

32 on page 26

- The main unit and remote control are configured as a pair.
Install the included item only.

Example: For remote control No. 12345678

Remote control back side

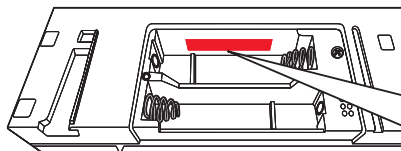

12345678

Main unit back side

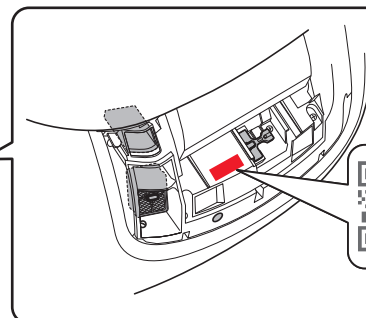
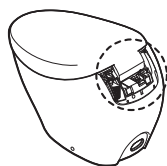

12345678

Check the numbers on the main unit and remote control (8 digits) to confirm that they are a pair.

Safety Precautions

Be sure to read these Safety Precautions carefully prior to installation, and always be sure to follow the safety warnings and instructions.

 WARNING	<p>This symbol indicates misuse may result in death or serious injury.</p>	 CAUTION	<p>This symbol indicates misuse may result in injury or physical damage.</p>
--------------------	--	--------------------	--

WARNING

- **Do not use this product with any power supply other than the one specified .**
(Doing so may result in heat or fire.)
- **Do not use the product when the power cord or power source connection is damaged or the power source connection is loose.**
(Doing so may result in electrical shock or fire.)
- **Do not install a power connecting part directly beneath a water supply location. Do not allow the water supply hose to touch the power connecting part.**
(Condensation may seep into the outlet, resulting in fire or electrical shock.)
- **Use only potable water according to the laws and ordinances of the region of use.**
Do not use seawater or reclaimed water.
(Doing so may result in skin inflammation or other ailments.)
- **Do not install the product on moving vehicles such as boats or RV's.**
(Doing so could cause a fire, electric shock, a short circuit, or other malfunctions. The toilet seat, lid, product main body or other part might come loose and fall off, resulting in injury.)
- **Do not do anything that may damage the power cord or power source connection.**
Do not strike, yank, twist, excessively bend, damage, alter, or heat any power cord or power source connection. Also, do not place anything heavy on, bind or pinch them.
(Using a damaged electrical cord may result in a fire, electrical shock, heat or a short circuit.)

WARNING

- **Do not exceed the rated capacity of your electrical outlets or wiring equipment.*1**
(Using a single outlet to supply power to many devices by using an extension cord or other adapters may result in fire from excess heat.)
- **Do not use this product in environments subject to temperatures of 0 ° or below.**
(The toilet may freeze and break, causing injury or leaks that may damage property.)
- **Be sure to plug the power cord (A-3) all the way into the wall socket (A-3-1).*1**
Confirm that the power source connection is connected correctly.*2
(Doing so may result in electrical shock or fire.)
- **Always use a grounded (3-prong) electrical outlet and that is connected to a ground fault circuit interrupter (30 mA or less).**
- **Make sure to waterproof the power plug by using a silicon rubber sealant.*1**
(A power plug that has not been waterproofed may cause fire or electric shock.)
*If the power plug is not waterproof, ask the installer to waterproof it.
- **To unplug, hold the power plug, not the power cord.*1**
Do not unplug by pulling the power cord.*1
(Pulling on the power cord may cause damage and result in fire or heat.)
- **This is an electrical product. Do not locate it anywhere water is likely to get on it. Do not locate the product in a humid environment where water may form on the surface of the product. When using the product in a bathroom, install a ventilation fan or opening, so that the bathroom has sufficient airflow to avoid extreme humidity.**
(Failure to do so may result in electrical shock or fire.)
- **When carrying this product by itself, always hold it by the porcelain section. Carrying it by holding any other section could break the product, causing injury, material damage or a water leak.**
- **If the electric cord is damaged, avoid danger by having the manufacturer's repair department or equivalent specialist replace it.**
- **Always connect the product to the cold water supply.**
(Connecting to hot water supply may result in burns and equipment damage.)
- **When installing this product, comply with the regional codes and standards on installation work.**
- **Check that the product is electrically grounded appropriately.**
(If a ground is not installed, a breakdown or electrical current leak may result in electrical shock.)
For a ground, use copper wire with a ground resistance of 100 Ω max. and a diameter of 1.6 mm min.
*If there is no ground installed, ask the installer to put in a ground.
- **Confirm that wiring is connected correctly (L terminal: Live, N terminal: Neutral).**
(Incorrect wiring may cause mechanical failure)
- **All-pole disconnection incorporated in the fixed wiring shall be provided.**

*1 If the product has a power plug.

*2 If the product does not have a power plug.

CAUTION

- **Do not subject the toilet to strong forces or impacts.**
(Otherwise, the toilet may break, causing injury or leaks that may damage property.)
- **Do not lift the product by the toilet seat or toilet lid.**
(Doing so may result in the product main body dislodging, falling and causing injury.)
- **Do not excessively bend the flexible water supply hose, or damage it with cigarette fire, a cutter, etc.**
(Doing so could damage or cause water leaks in the flexible water supply hose that could result in flooding damage to property, such as household belongings.)
- **Do not remove the water filter with the shutoff valve left open.**
(Leaving the shutoff valve open could cause water to spray that could result in flooding damage to property, such as household belongings.)
- **Carry out the installation work according to this manual.**
(Otherwise, damage or water leaks may occur.)
- **Be sure to use the included or specified parts for installation work.**
(Otherwise, parts may not be attached correctly.)
- **Be sure to carry and install this product with at least two people.**
(Otherwise, you could injure your lower back or drop the toilet bowl, causing damage and injury.)
- **Make sure that the water filter is tight after installation.**
(Failure to securely tighten it may cause a water leak.)
- **Make sure the plus and minus signs on the batteries are aligned correctly before inserting them.**
(Otherwise, the batteries may leak fluid, generate heat, rupture, or ignite.)
- **When the product will not be used for a long time, remove the batteries from the remote control and the battery box.**
(Failure to do so may cause the batteries to leak fluid.)

- This product is classified as Class I Equipment and must be grounded.
- Install this equipment so that the electrical outlet and power breaker are accessible.
- Use the new hose set included with this equipment. Do not reuse an old hose set.

Precautions before installation

- Make sure that dirt from the silicone-based seal material does not adhere within the toilet bowl.
- Secure the space required for toilet installation and at the same time, check door opening/closing for possible interference.
- Turn on the electricity and water supply for the product only after all other installation work is complete.
- Do not damage the connection components on the water supply hose.
- For water supply, ensure that the minimum required water pressure (flowing) is 0.2 MPa at 10 L/min. (while maximum water pressure is 0.75 MPa)

The product automatically measures water pressure conditions in the operating environment during toilet bowl cleaning and adjusts the volume of toilet bowl flush water used.

- The temperature of the water supply should be within a range of 0 to 35 °C. Make sure the temperature is within this range.
- Working ambient temperature is within the range of 0 to 40 °C. Make sure the temperature is within this range.
- Prepare an outlet position in advance that conforms to the regulations in your country.
- Make sure before installation that the water supply source and water drain pipe are in the specified positions according to the diagram.
- If there is a gap between the discharge pipe and floor, fill it with mold-resistant silicone-based seal material (Mediseal).

Doing otherwise may cause water to leak downstairs.

- Perform wiring according to the product specifications (rated 15 A or higher, 120 V AC at 60 Hz).

* Power supply, rated power consumption is indicated on the label of this product.

- The power cord is 1.2 m.

Check that the outlet is provided in a location appropriate for this length.

- Because a water flow test is conducted on each product at the factory, water may remain inside the product.

This water does not indicate a problem with the product.

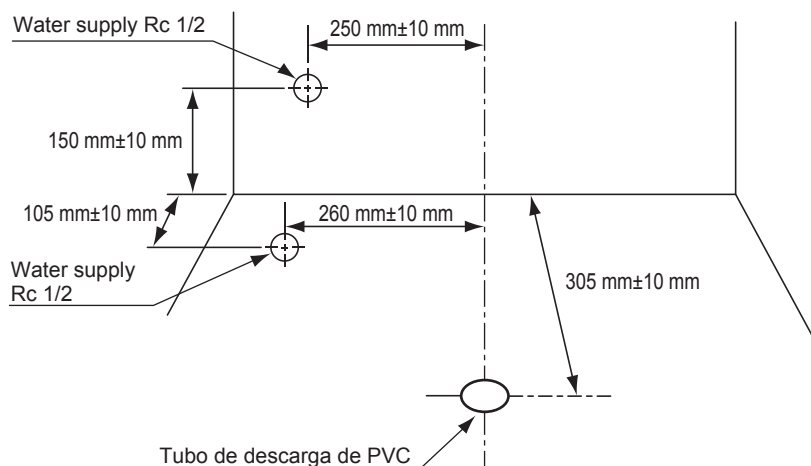

- Before installing the product, be sure to completely wash out any dirt, sand, etc. from inside the water supply pipe.

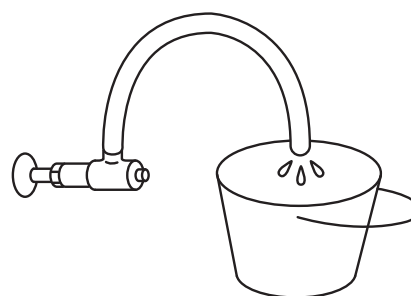

Included Parts

* Refer to the following and confirm that no parts are missing.

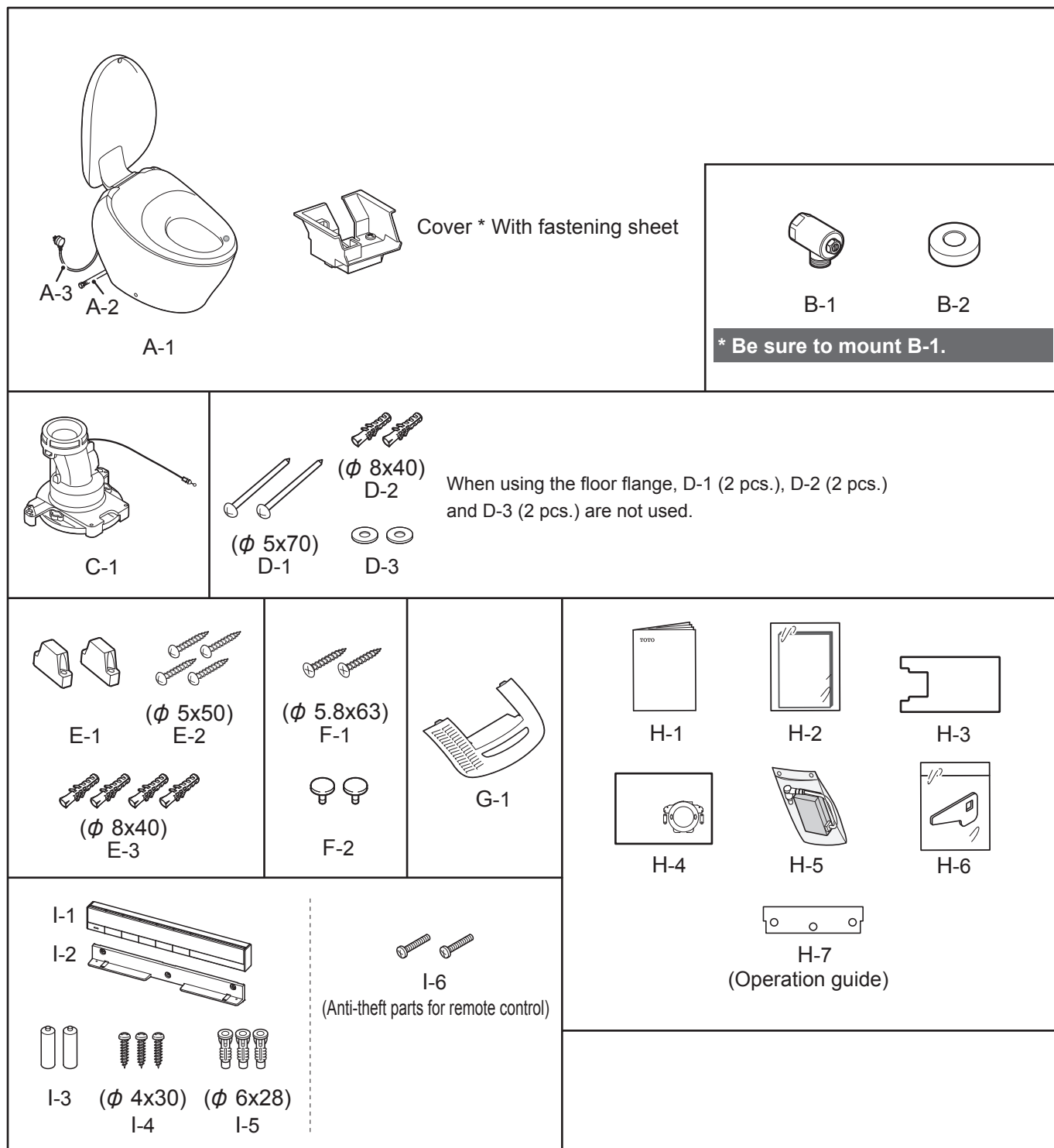

Ask the customer if they would like H-7 and I-6 installed before beginning installation. If they will not be used, be sure to hand them over to the customer.

* The product may be slightly different in shape than the product shown in the figure depending on the model.

Required items

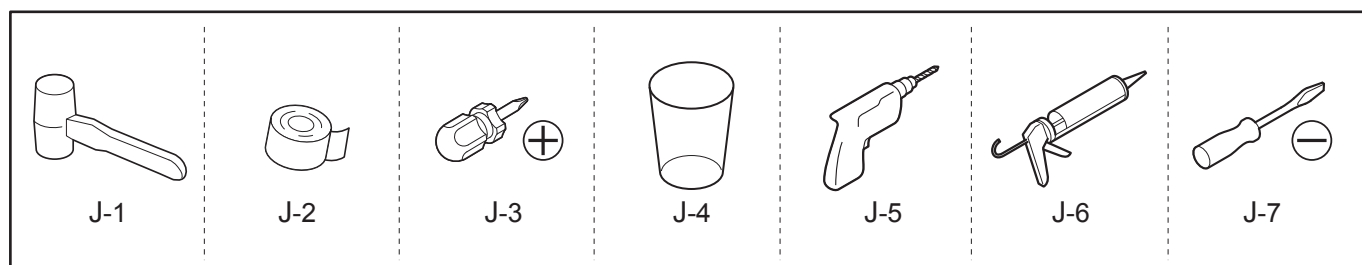

Part diagram

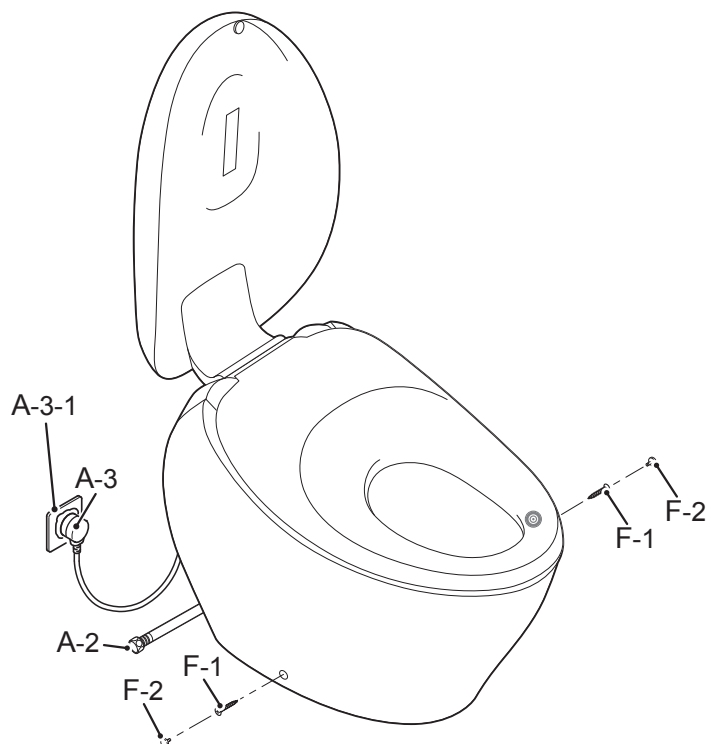

For water supply from the wall

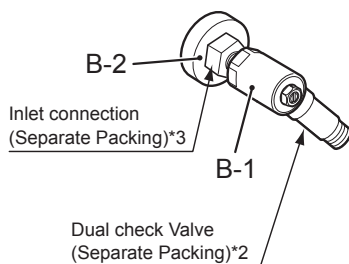

*2 Dual check valve is not included with the product. It must be arranged separately.

Manufacturer : Galvin Engineering Pty Ltd
Part no. : 370457

*3 Inlet connection is not included with the product.
It must be arranged separately.
Kinetic 1/2" BSP MF adaptor
Code: 4710000
WM70001

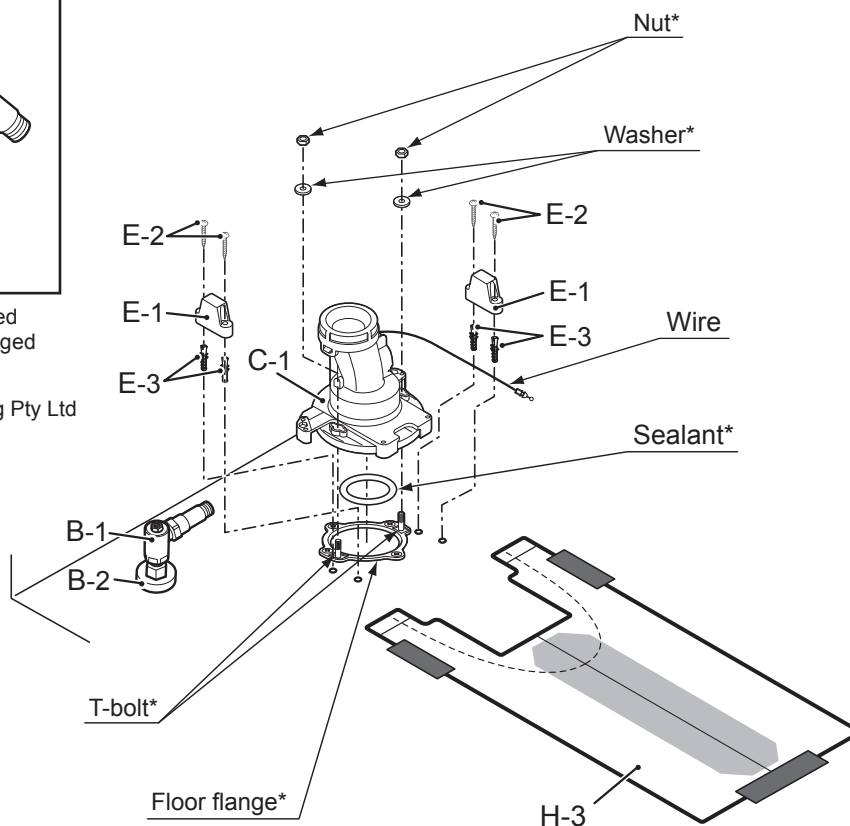
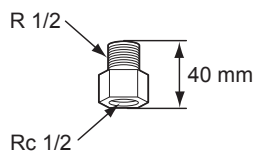

*The floor flange, T-bolt and sealant are not included.

CAUTION Be sure to install the shutoff valve (B-1) included with the toilet.
Dirt contamination could cause shutoff or discharge defects.

Installation procedure

Symbols and their meanings



: Tasks that must be conducted by the installer.



: Actions that the unit should perform automatically.



: Visual confirmation required.



: Work flow direction.

1

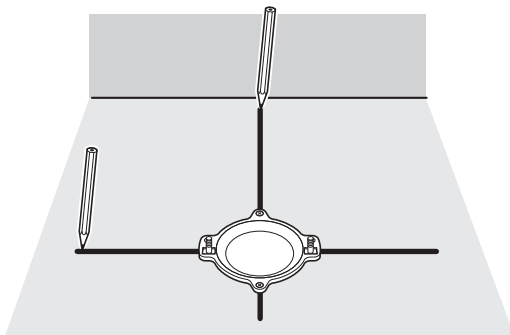

2

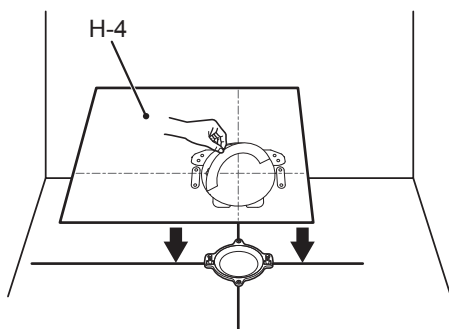

3

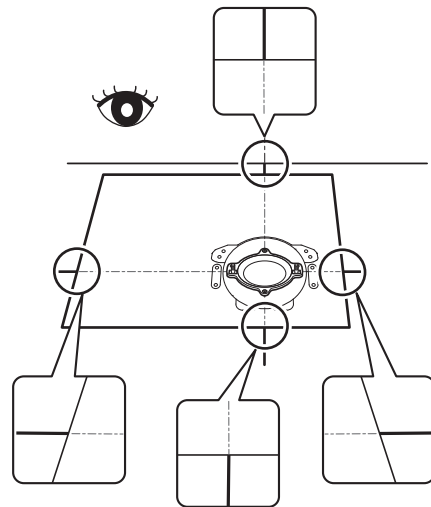

4

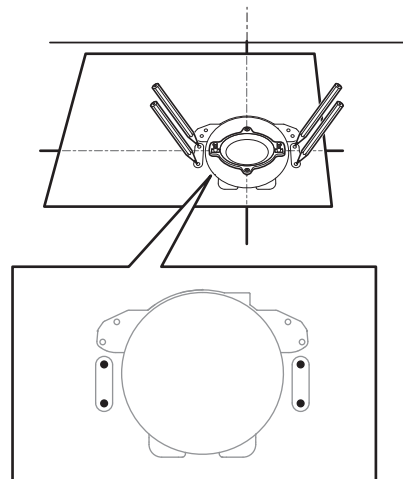

5

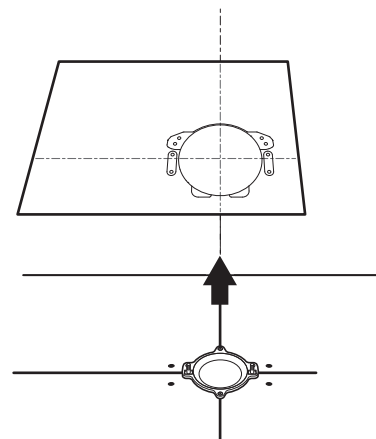

Confirm the direction of the water supply hose for the shutoff valve prior to installation!

Shutoff valve installation direction for floor water supply

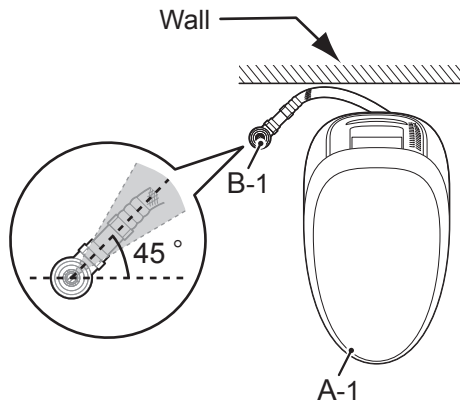

Shutoff valve installation direction for wall water supply

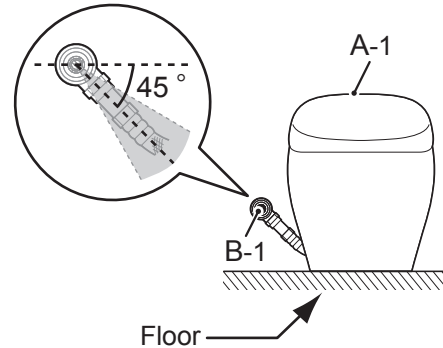

! CAUTION



Install the water supply hose for the shutoff valve at an angle of 45 °
Installation in the wrong direction could cause flushing defects or water leaks.

* For right water supply, install in the water supply removal direction bilaterally symmetric with the left water supply in the figure above.

<For water supply from the floor>

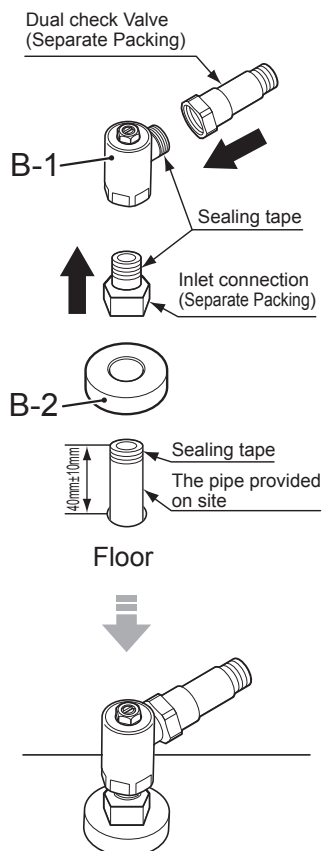

<For water supply from the wall>

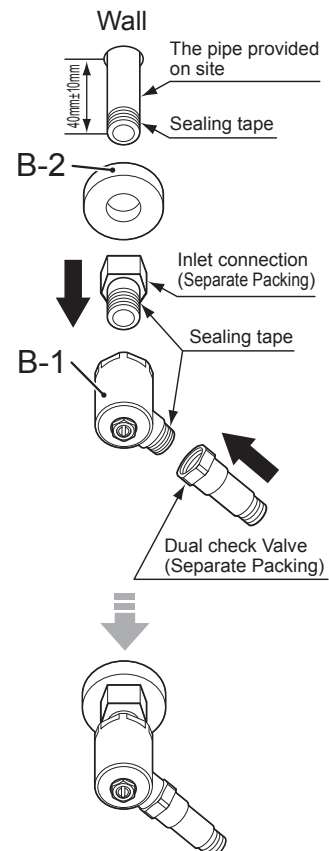

CAUTION

- If there is a gap between the straight pipe and the floor, fill it with mold-resistant silicone-based seal material (Mediseal), and then attach a cover seal(B-3). Doing otherwise may cause water to leak downstairs.
- Be sure to install the shutoff valve (B-1) included with the toilet. Dirt contamination could cause shutoff or discharge defects.

7

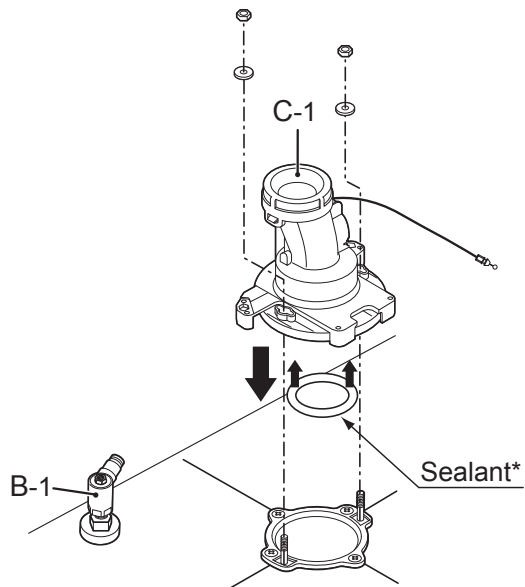

CAUTION Set so that the sealant does not enter the drainage channel area (in the hatched area). Doing otherwise may cause inadequate flushing.

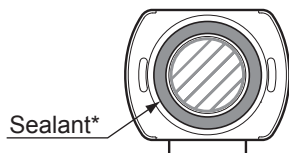

(Rear surface of floor flange connection area) *The figure is for a metal flange

! CAUTION

Caution in handling of the Sealant

(For plastic flange)

Sealant for plastic flange

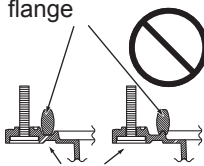

(For plastic flange)

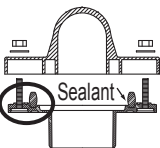

(For metal flange)

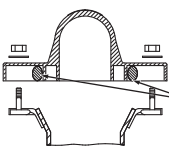

Sealant



Required

8

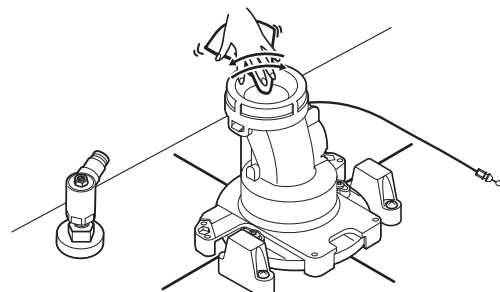
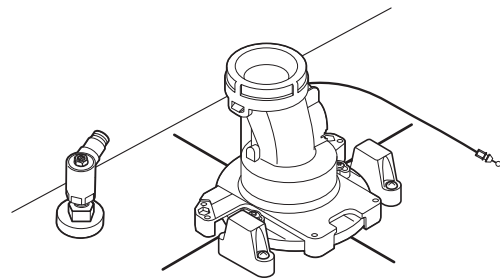
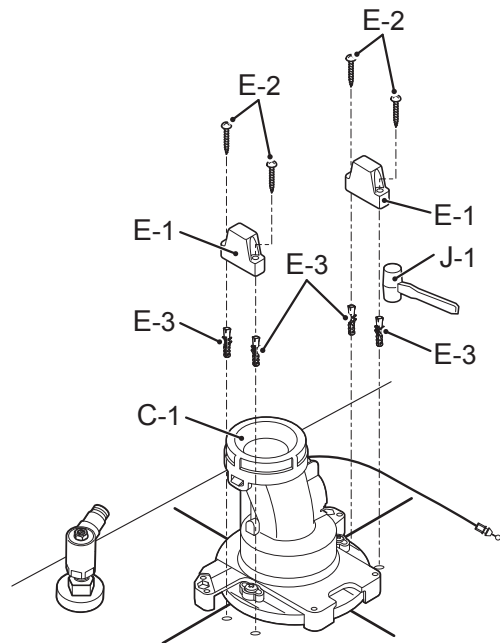

9

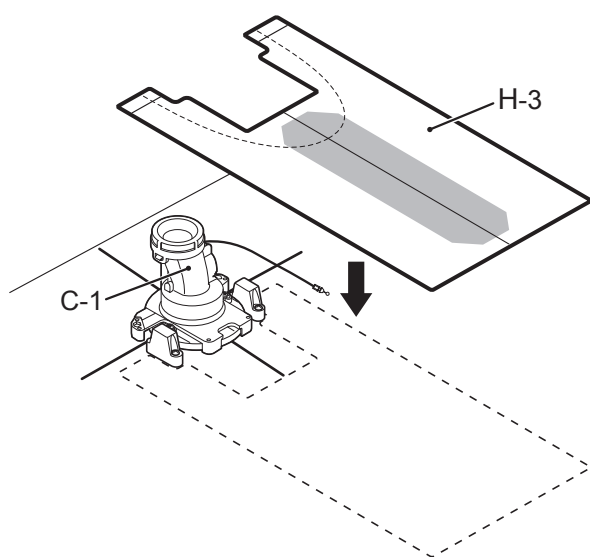

* Confirm that there is no dirt, etc. when installing.

10

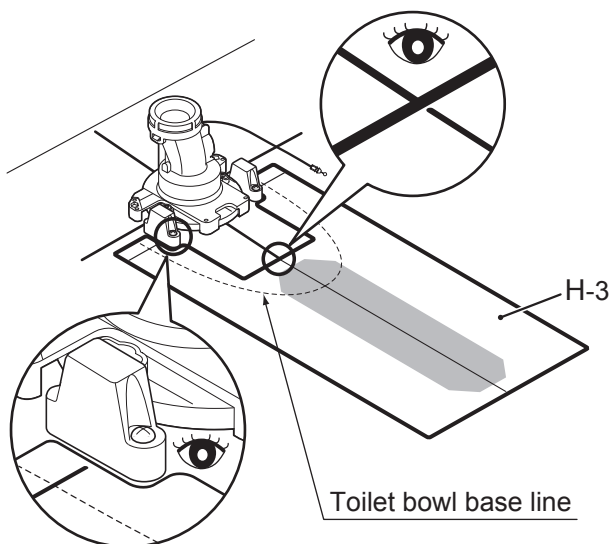

11

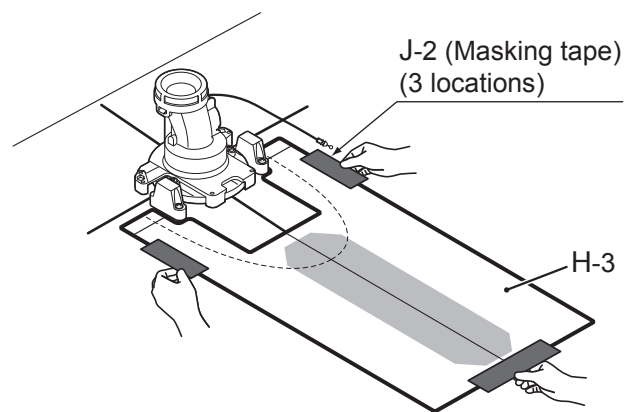

CAUTION Attach hygienic tape on the outside of the protective sheet. If it is attached on the inside, it will become impossible to remove the protective sheet after the toilet bowl is installed.

12

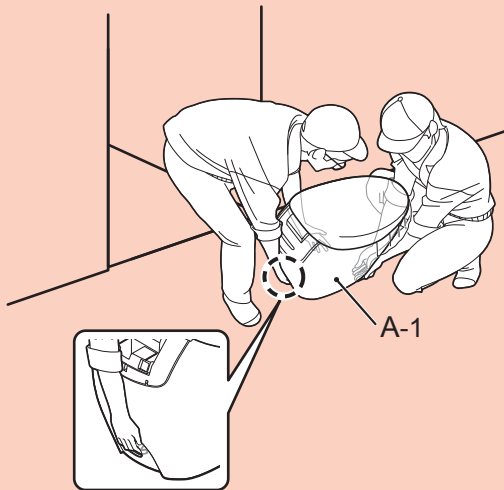

13

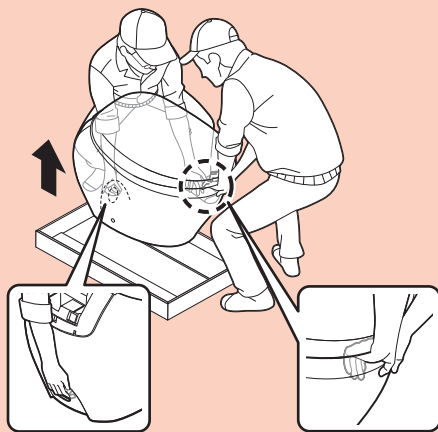

Or

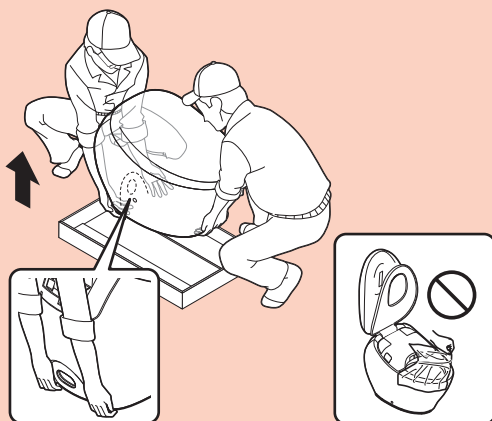

14

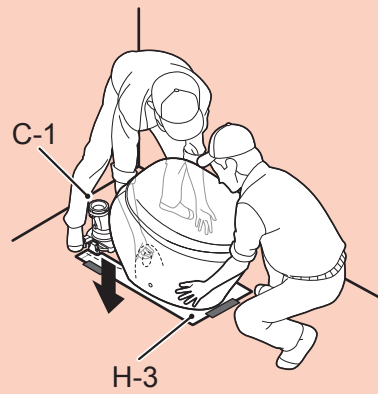

15

Installer ①

Go around the side of the toilet bowl (A-1) and lift the rear of the toilet bowl (A-1) up.

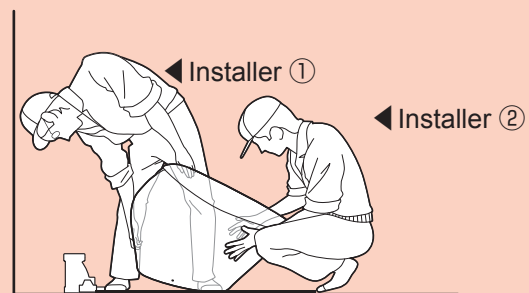

Installer ②

Support the toilet bowl (A-1) so that it does not fall over.

16

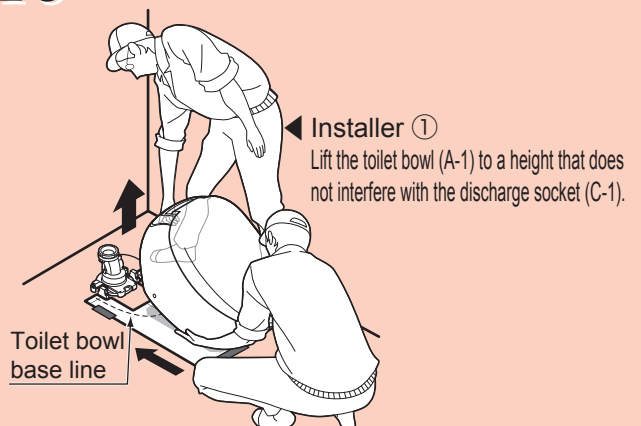

▲ Installer ②

Push the toilet bowl (A-1) to the rear.

Align with the toilet bowl base line on the protective sheet (H-3) and adjust the front/rear position.

Install so that the center lines on the center label and protective sheet are aligned.

17

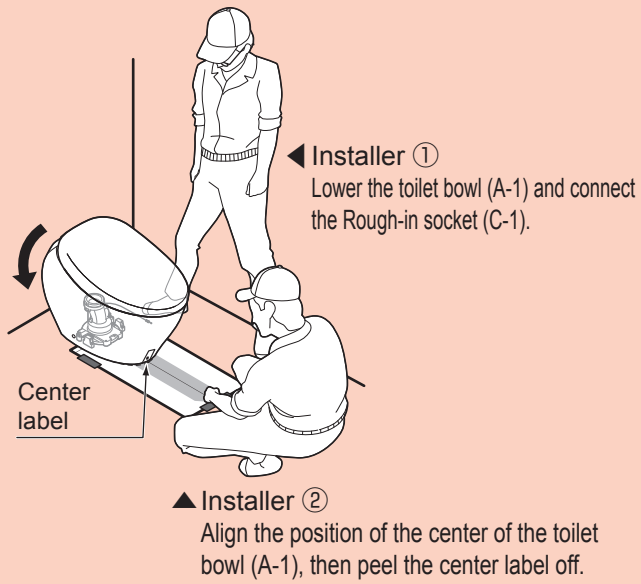

CAUTION

- When lowering the toilet bowl, be careful that your hand does not get pinched between it and the rear wall.
- When installing, be careful that the wire does not get pinched between the floor and discharge socket.

18

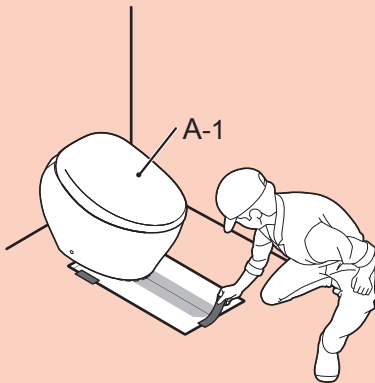

19

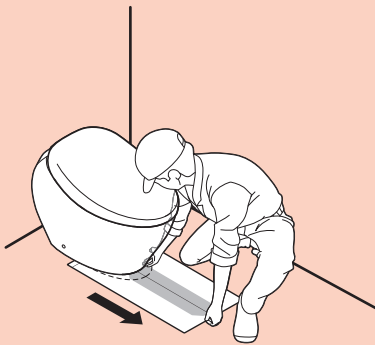

After installing the toilet bowl (A-1), confirm that there is no gap between the floor and base.

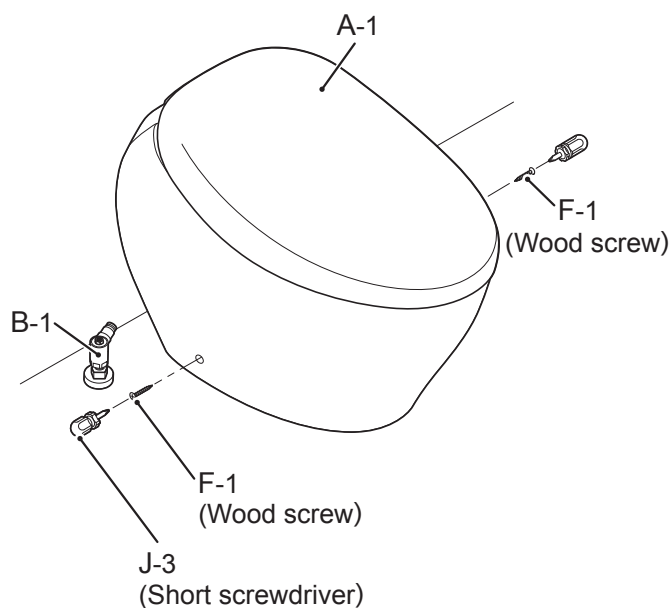
**CAUTION**

Perform final tightening by hand, and be careful not to break the toilet bowl.

CAUTION

- Make sure that wood screws are tightened level with the floor (not tilted).
- Use a short screwdriver if unable to tighten level with the floor (for example, if the installation area is narrow).

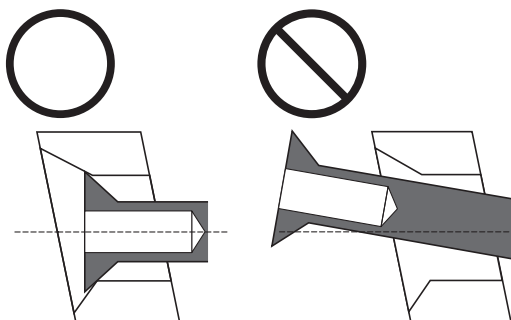

- Be careful not to over-tighten, as doing so could damage the toilet bowl.

CAUTION

Install the decorative caps so that the arrow on the back is pointing upward.

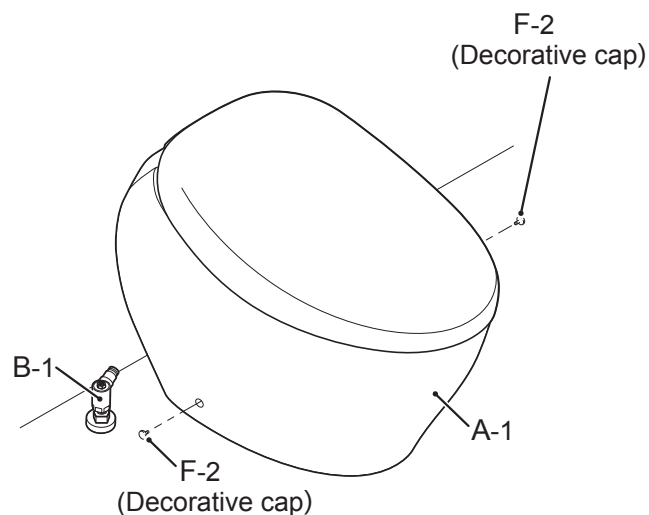
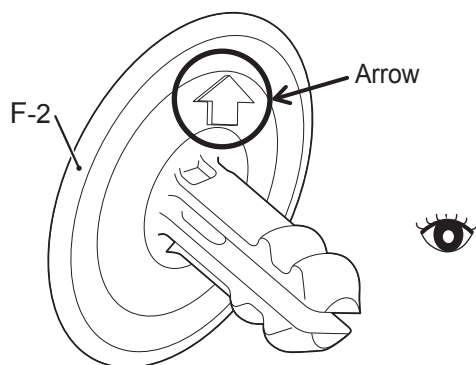
**CAUTION**

Confirm that the decorative caps are inserted into the installation holes on the toilet bowl.

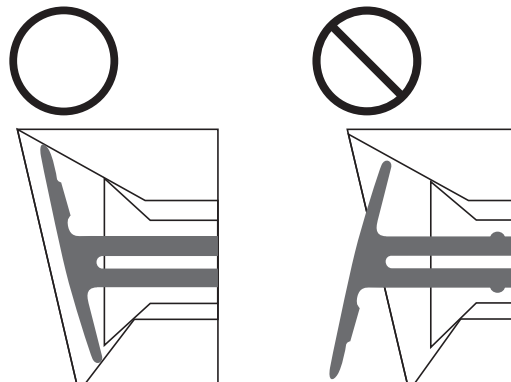

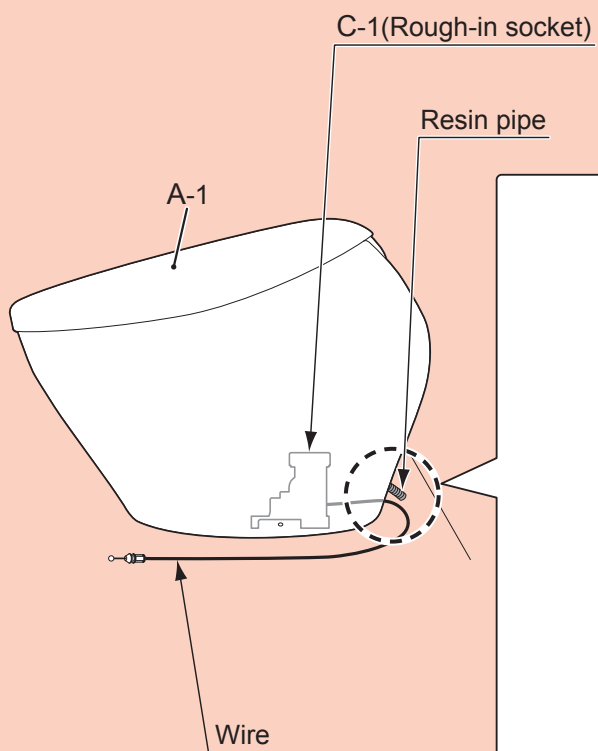

1

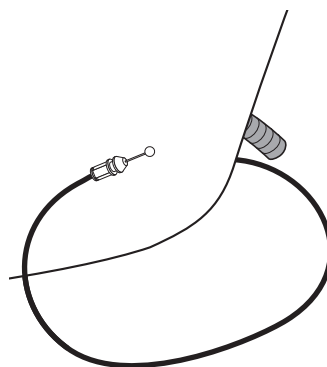

4

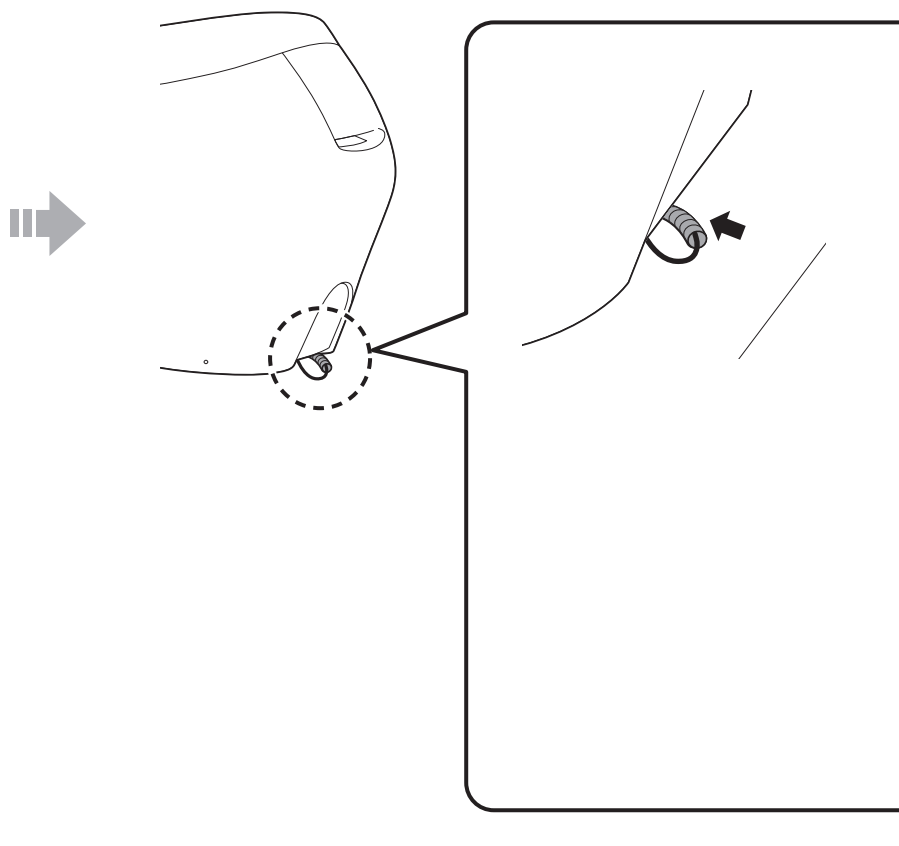

CAUTION Do not pull the resin pipe.
Doing so may cause damage.

2

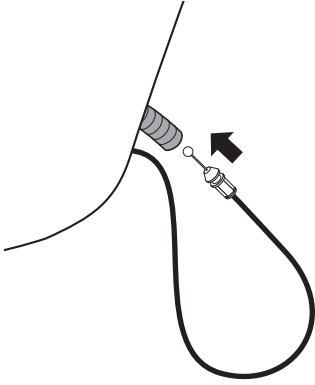

3

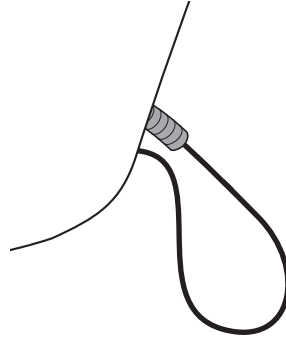

5

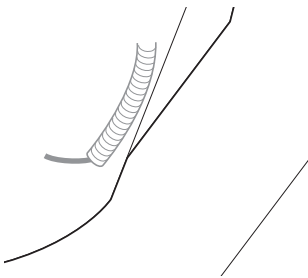
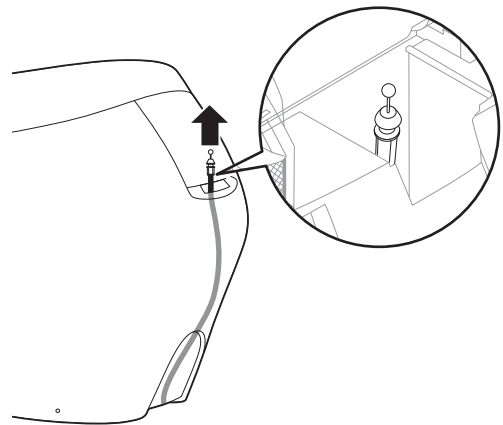

Insert the resin pipe into the inside of the toilet bowl (A-1), so that it is no longer visible.



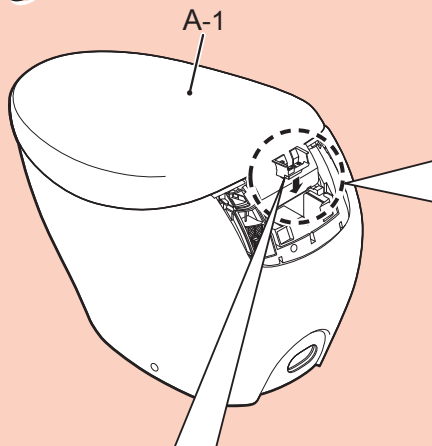

Cover **Included Parts**

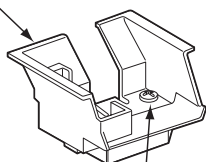

Fastening screw

1

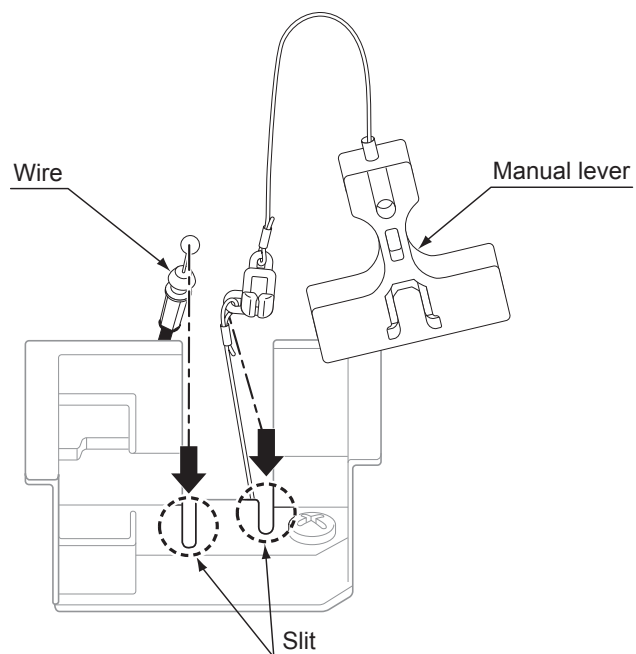
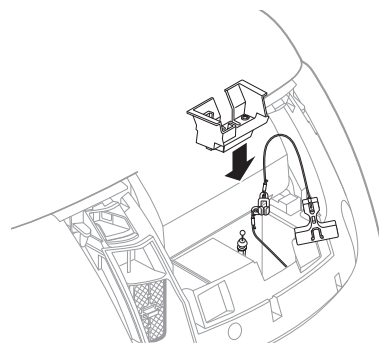

Key points

- ① If the wire is pulled out too much, it could become difficult to fasten the cover.
- ② When fastening the cover, adjusting the amount that the wire comes out can make it easier to fasten.
- ③ Apply caulking so that it is above the slit.

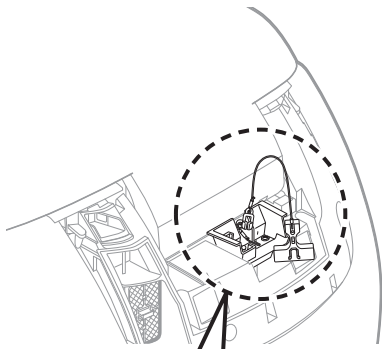

2

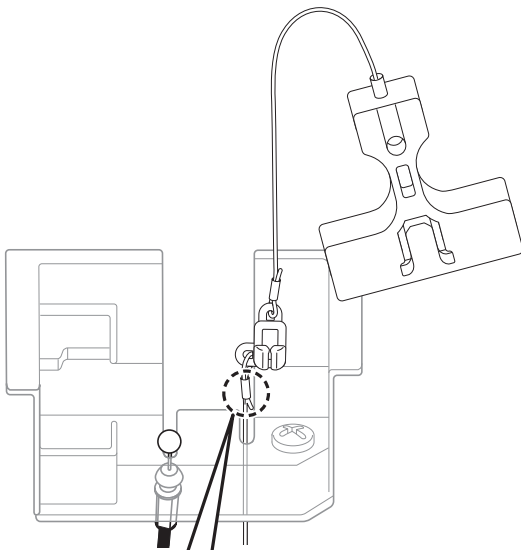
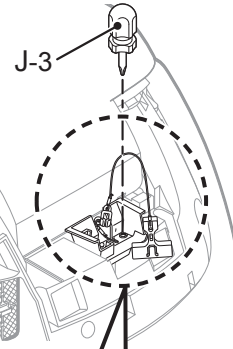

Caulking is on top

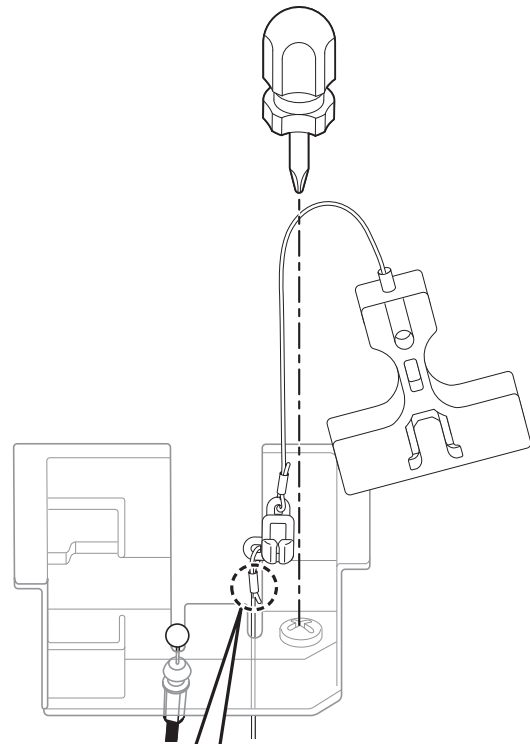

Caulking is on top



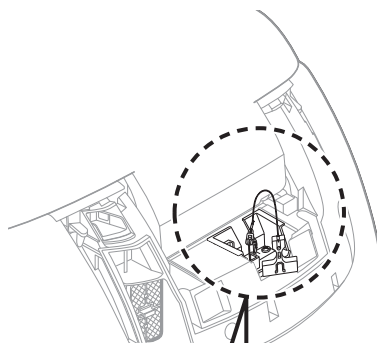
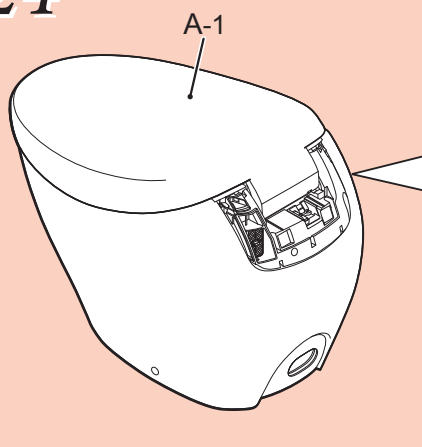

Manual lever
connector

Wire
end area

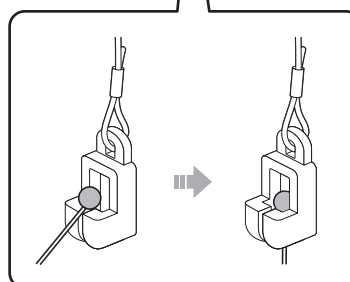
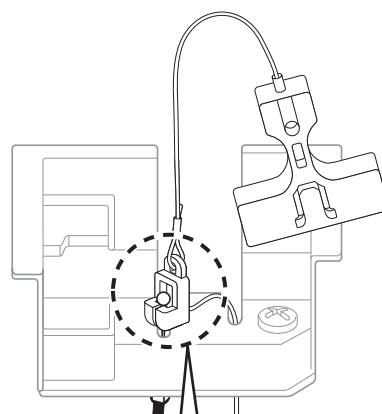
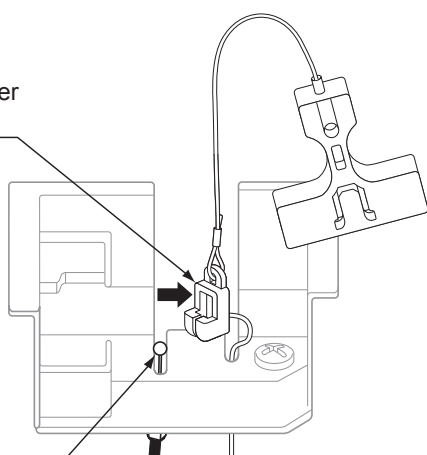

25

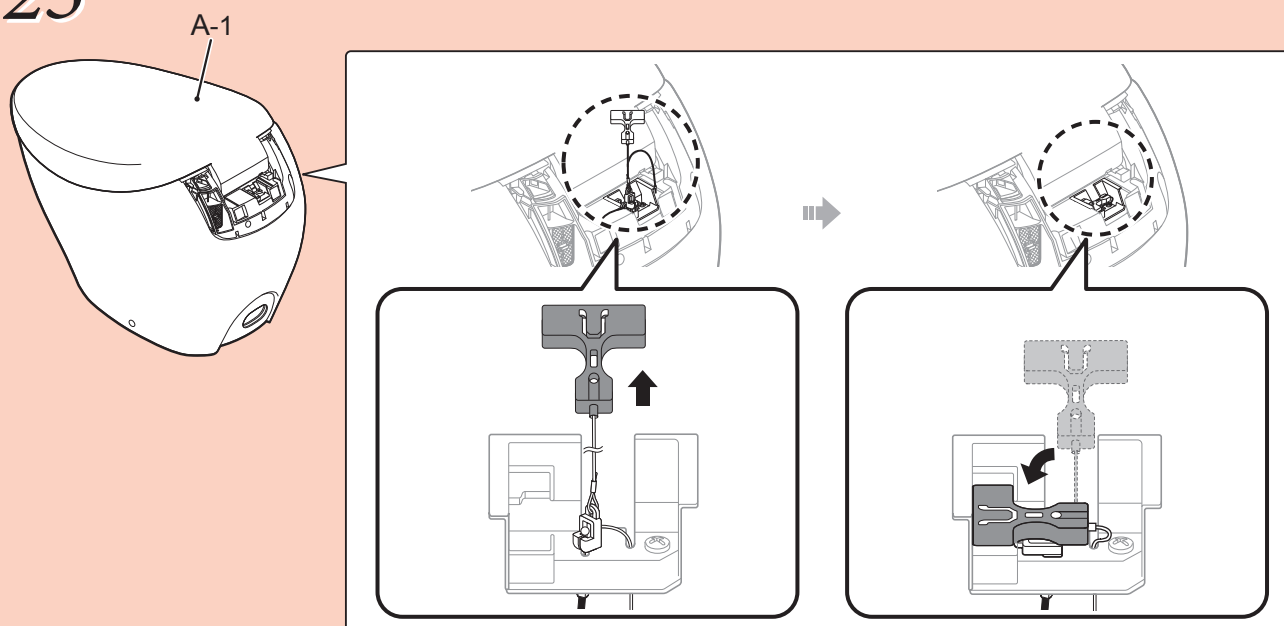

26

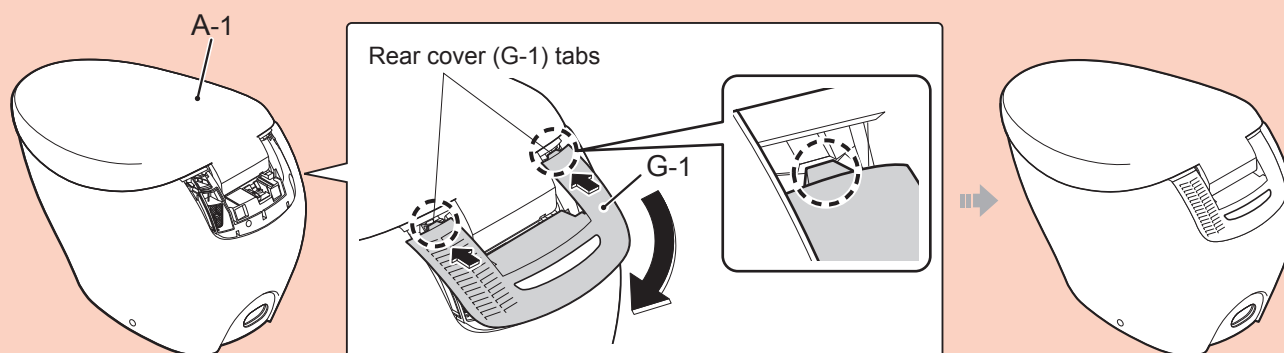

Insert the tabs securely.[Doing otherwise may cause damage to the rear cover (G-1).]

After installing the rear cover (G-1), check whether it is sticking up. If so, reinstall the cover.

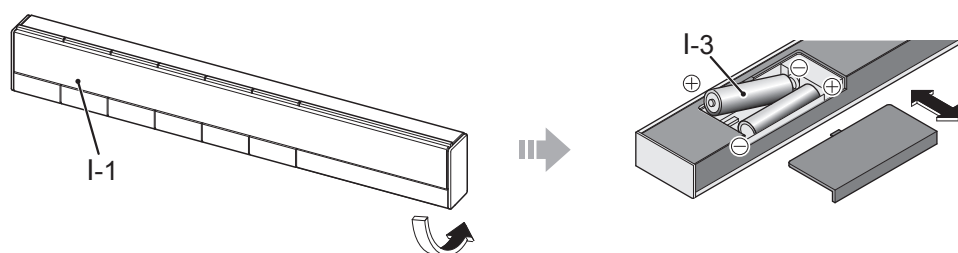
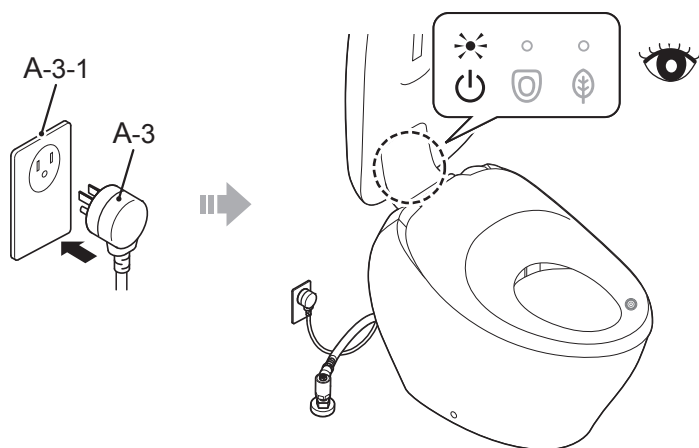
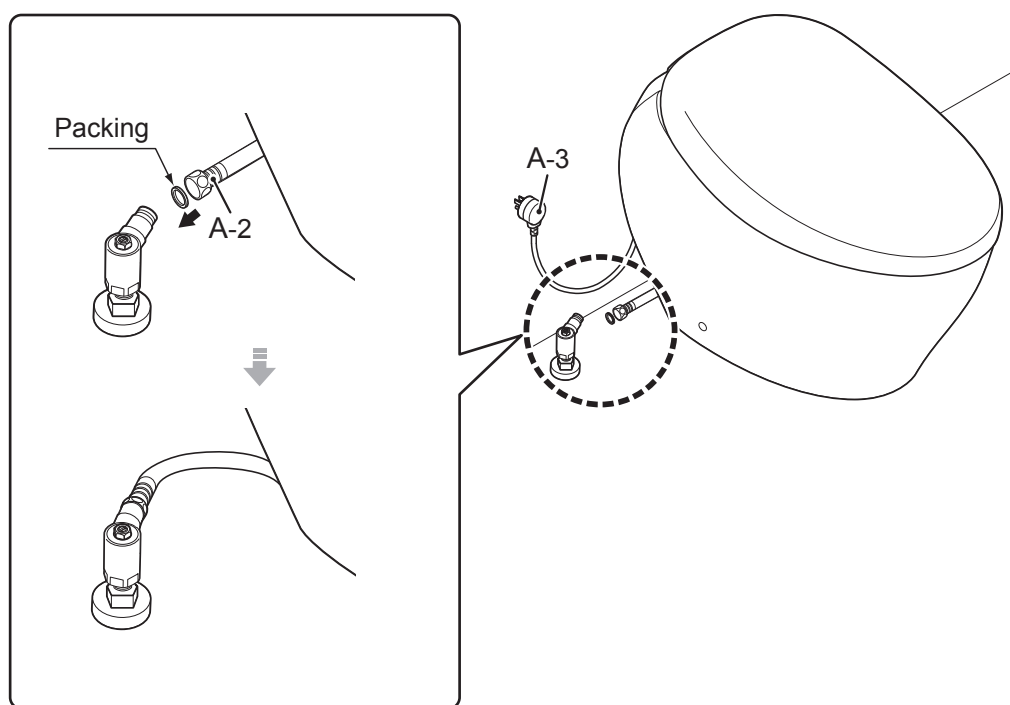

30

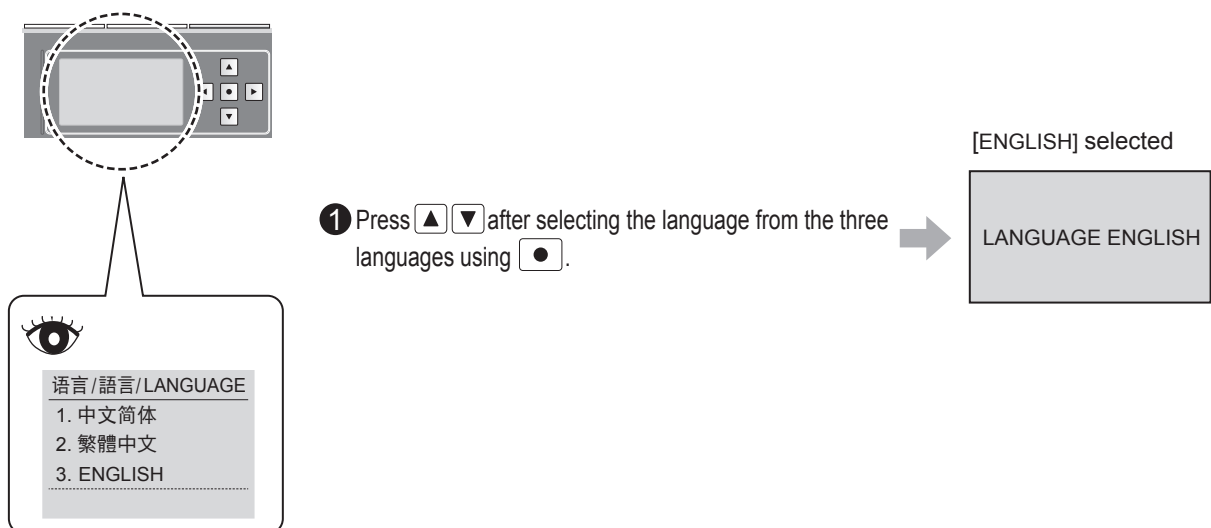

When the language was wrong

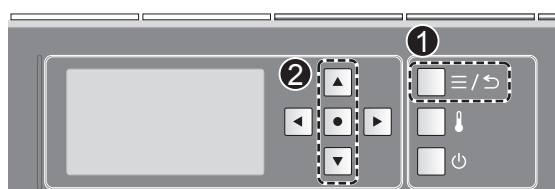

30

- 1 Press .
- 2 Use to select 5.语言 / 語言 / LANGUAGE and then press .

31

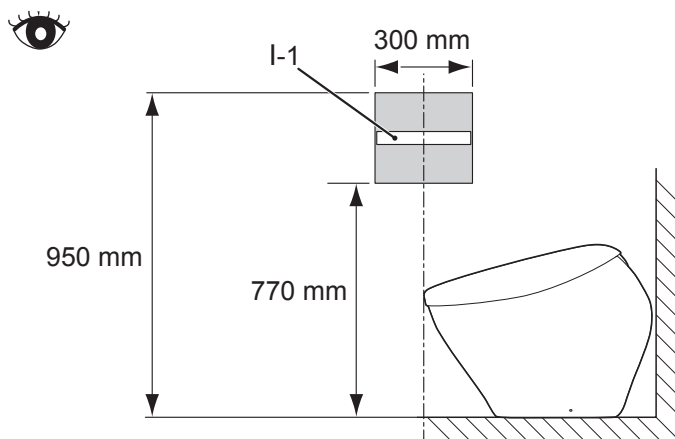

- ① Temporarily place the remote control in the position determined in **31** and confirm the signal reception of I-1.

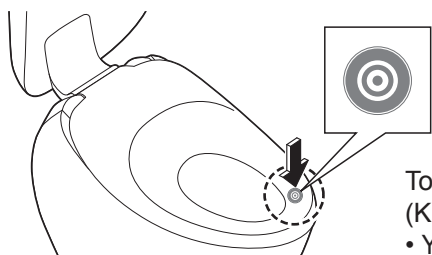

Touch the entire label (seat sensor area) with your hand or arm.
(Keep touching until ③.)

- Your skin must make direct contact with the sensor due to how it operates.
- Confirm that deodorization starts.

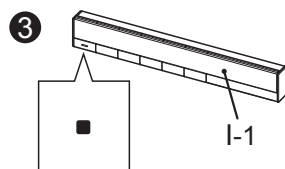
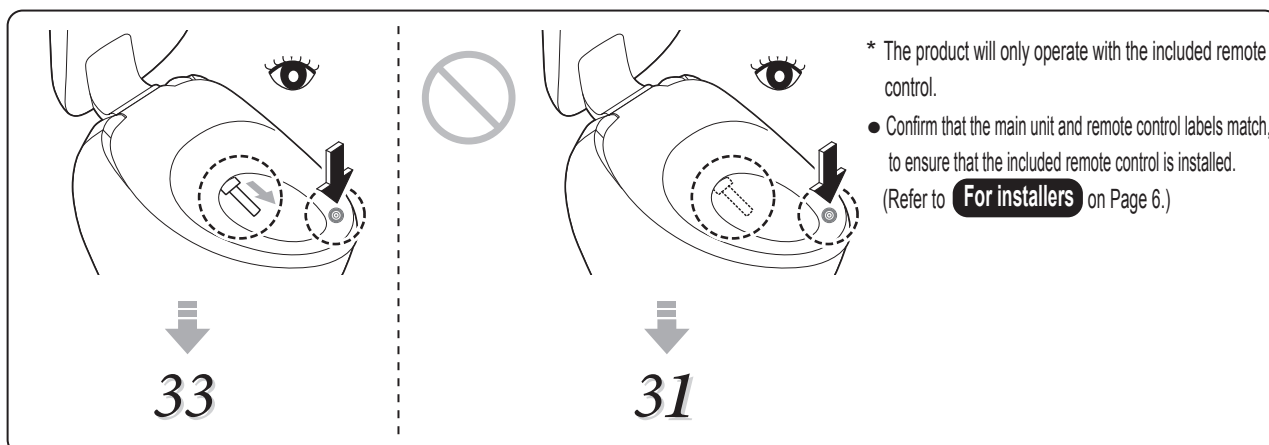
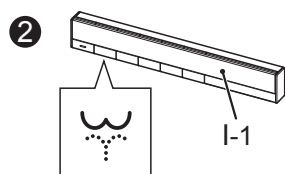

①

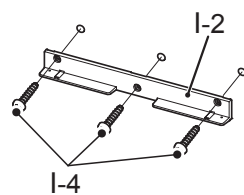
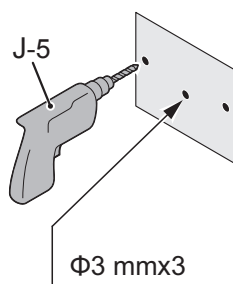

When mounting on a plaster board or tiled wall.

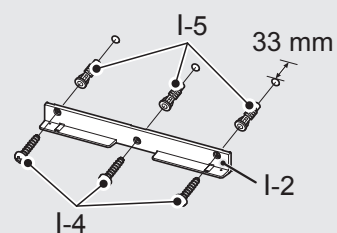

②

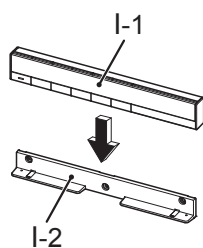

Anchored by magnet.

Trial run

Conduct the test run only after power supply work is finished.

34

Open the water shutoff valve (B-1).

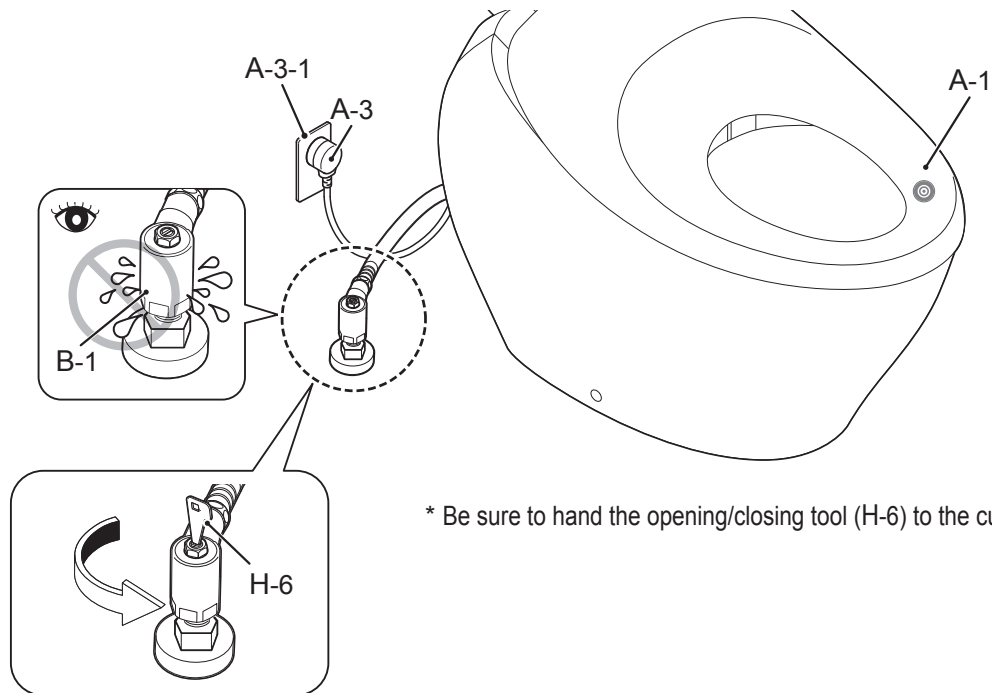

* Be sure to hand the opening/closing tool (H-6) to the customer after work is complete.

Is water flowing to the toilet bowl (A-1)?

→ The water will stop when the power plug (A-3) is inserted into A-3-1.

Keep the shutoff valve (B-1) closed until power supply work is complete.

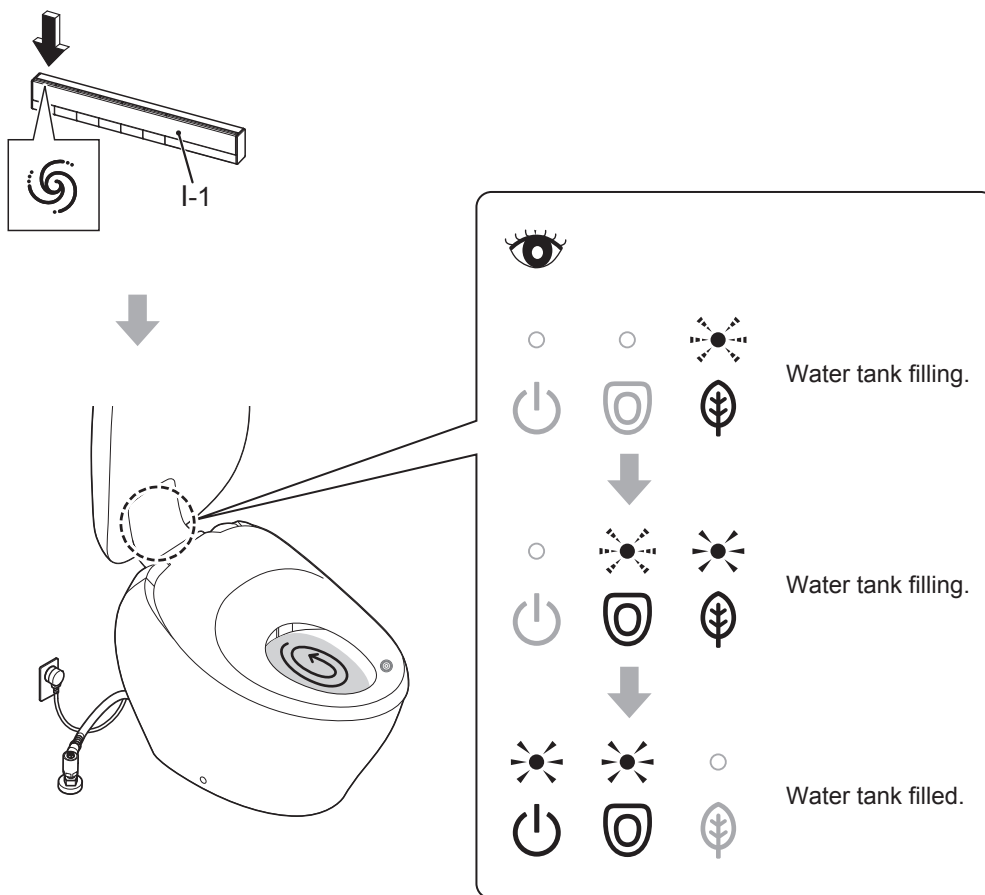

If the product does not operate after pressing buttons on the remote control

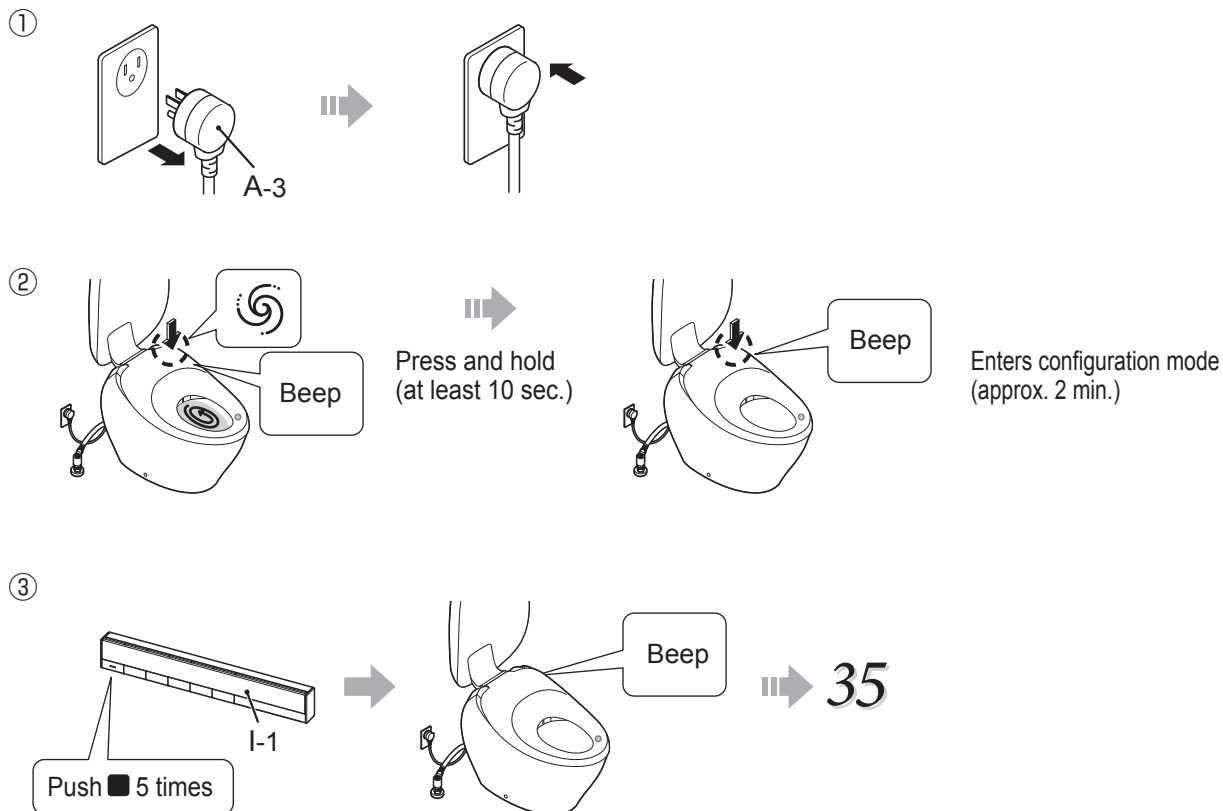

CAUTION Configure the product within approximately 2 minutes of entering configuration mode. If no beep sound is heard during step ③, restart from step ①.

36

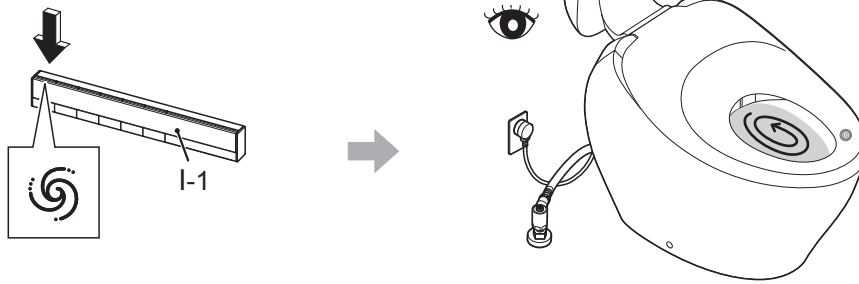

37



38

1

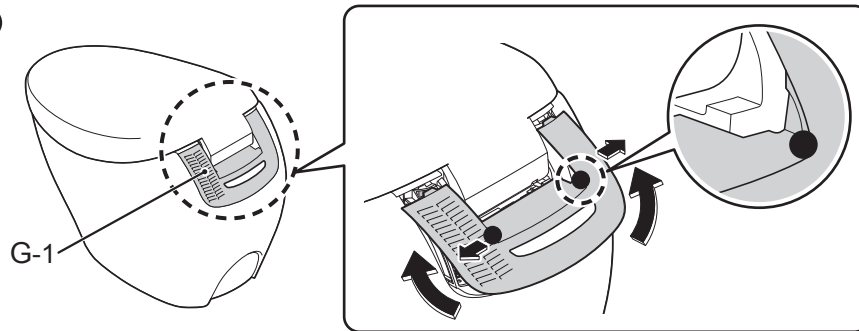

Remove the portion indicated by ● in the figure while pushing to the side.

2

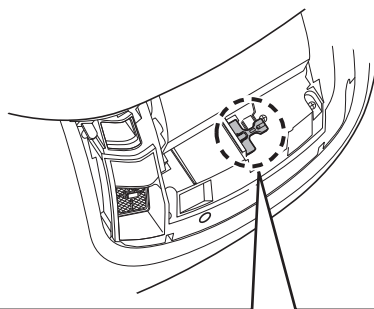

Continue pulling 30 sec.

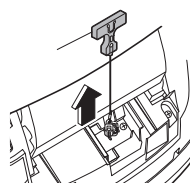

Two short beeps

The toilet bowl is filled with water.

③

Release and return to the original position

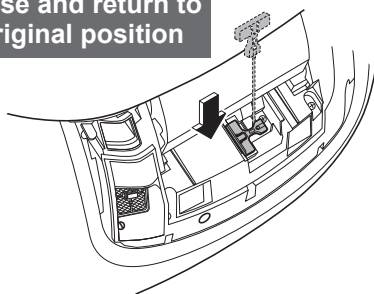

The water in the toilet bowl flushes when the manual lever is released.

* If the manual lever is released after or while flushing the toilet bowl, the toilet will not flush for about 60 seconds.

Wait at least 60 seconds, and then flush the toilet bowl again.



④

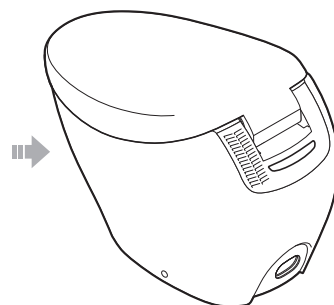
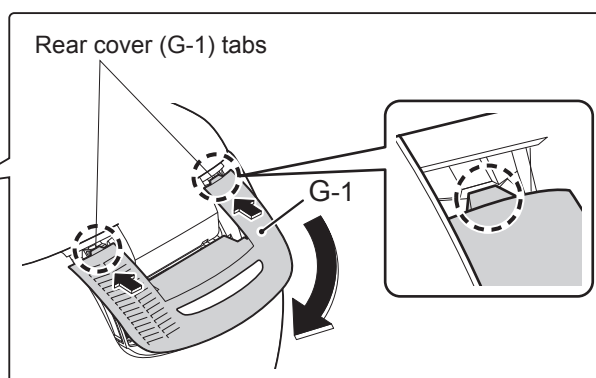
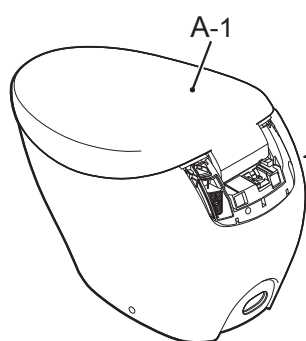

Insert the tabs securely.[Doing otherwise may cause damage to the rear cover (G-1).]

After installing the rear cover (G-1), check whether it is sticking up. If so, reinstall the cover.

➡ 23

39

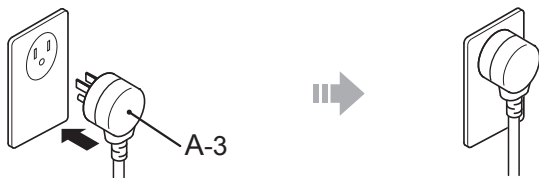

40

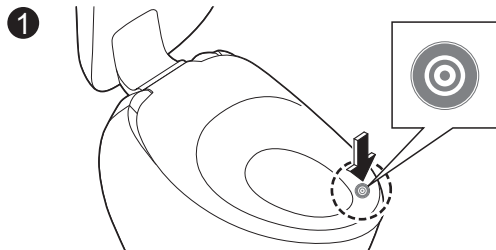

Touch the entire label (seat sensor area) with your hand or arm.
(Keep touching until ④.)

- Your skin must make direct contact with the sensor due to how it operates.

→ Confirm that deodorization starts.

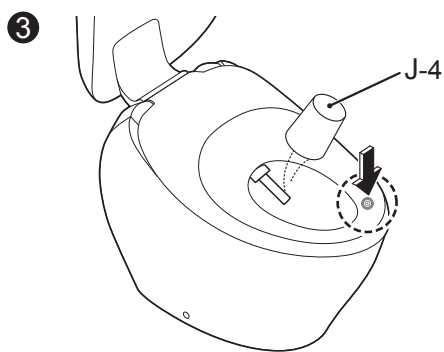
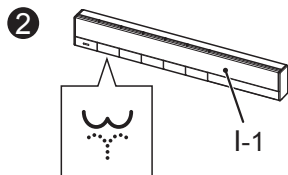

④ Release your hand or arm from the entire label (seat sensor area) in the figure above.

Cleaning the Water Filter (after Trial run)

41

[Toilet bowl]

①

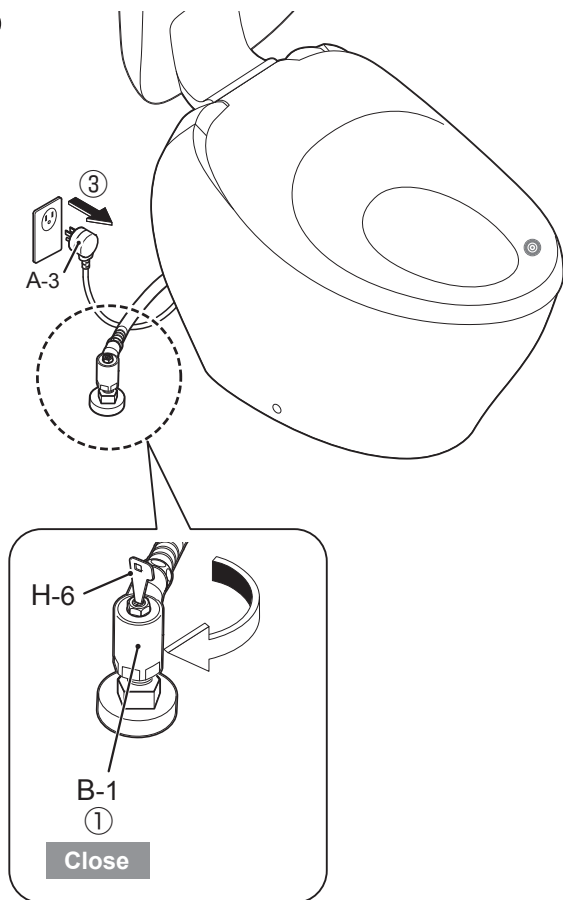

②

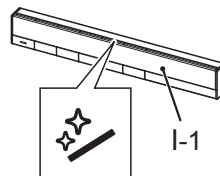

- Opens the wand cover.
(Release the pressure from the water supply pipe.)

②

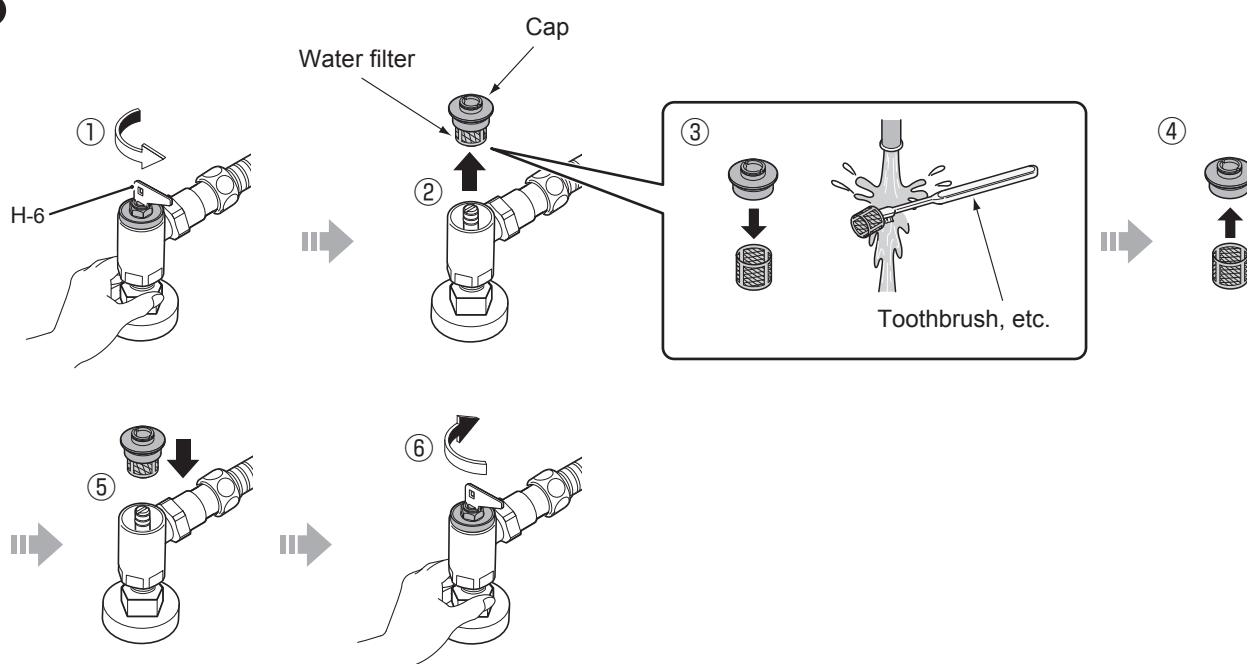

CAUTION Failure to securely tighten the drain valve may cause a water leak.

③

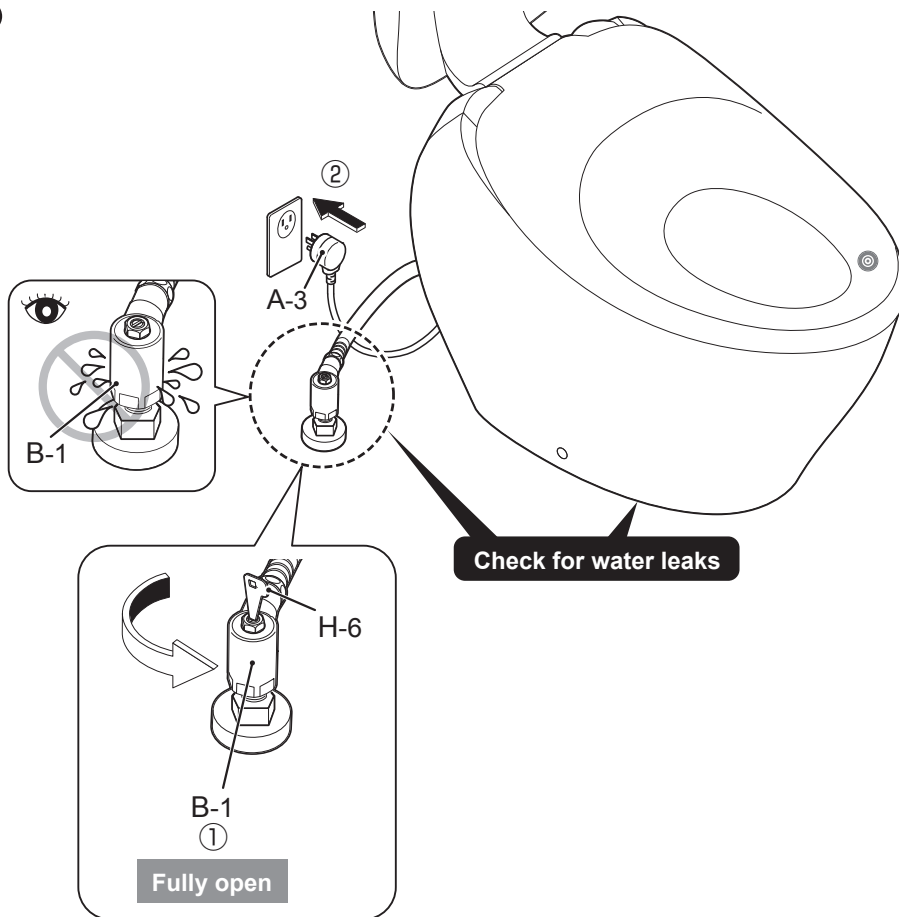

①

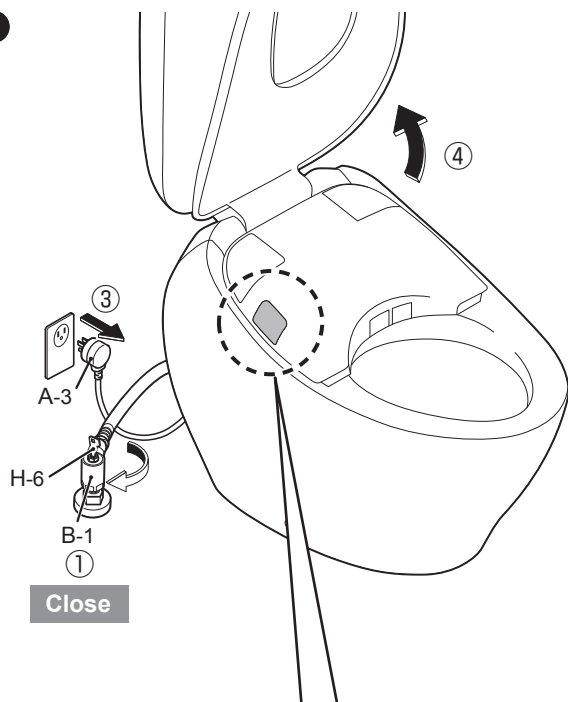

②

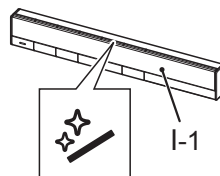

- Opens the wand cover.
(Release the pressure from the water supply pipe.)

⑤

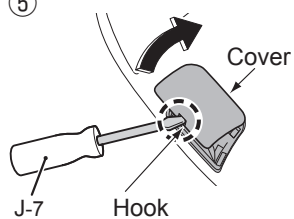

⑥

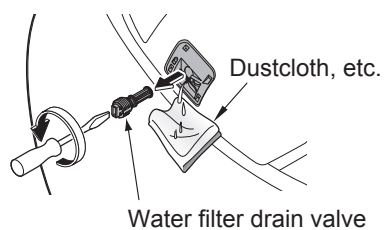

⑦

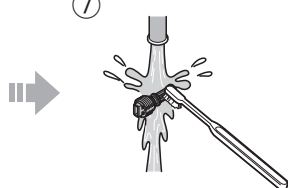

⑧

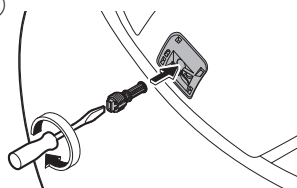

(Continued)

2

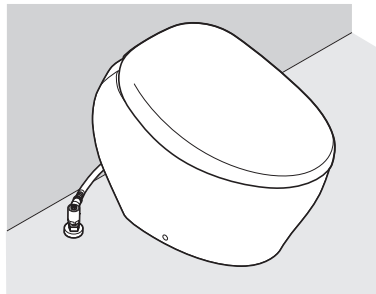
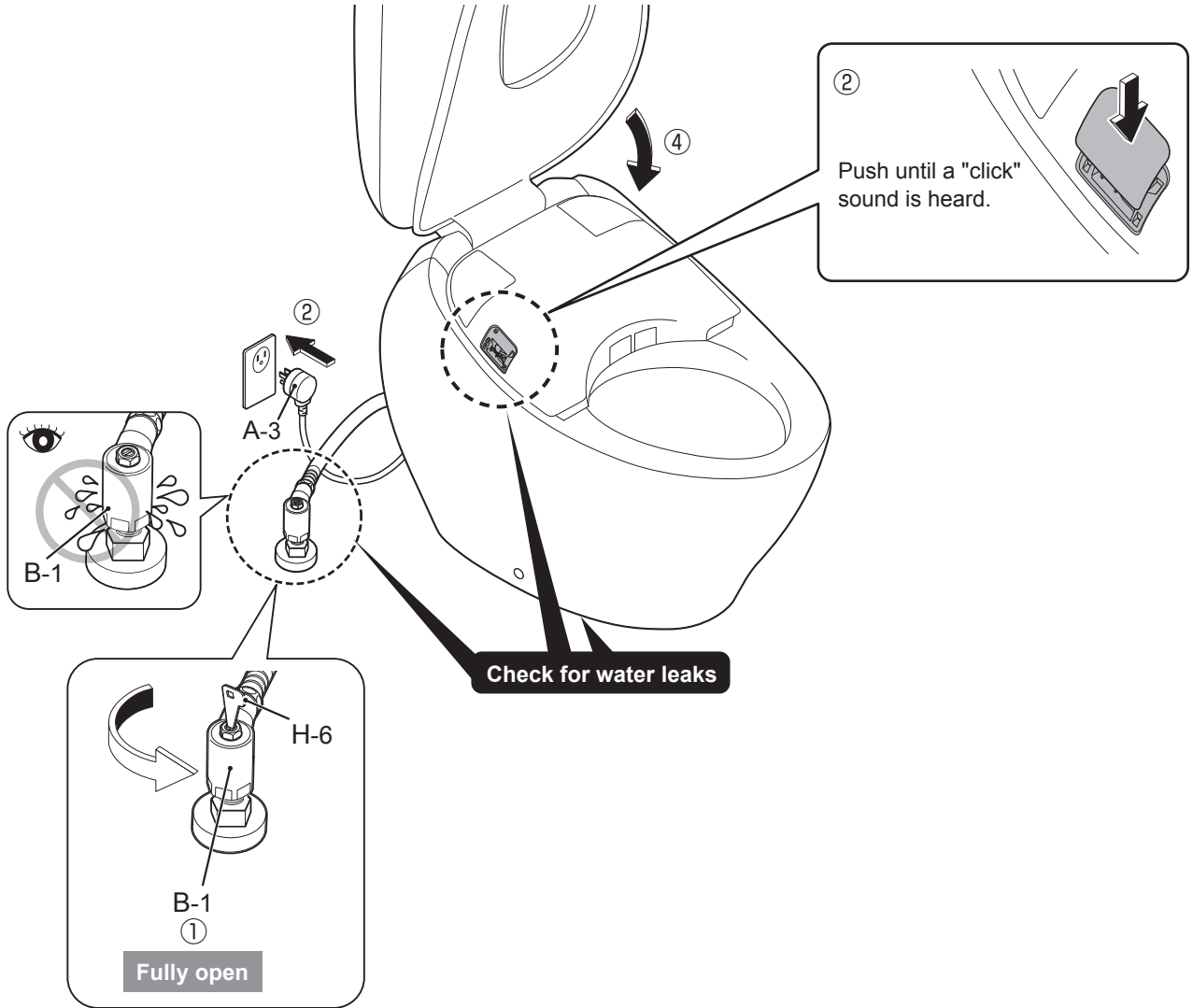

44

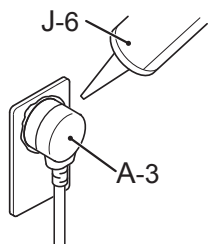

45

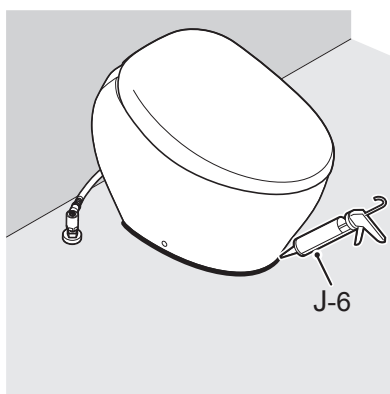

- After the trial-run (flush) of the toilet bowl, check the toilet bowl inside for foreign matter such as chips of cut pipe, etc. Foreign matters such as transmitted rust can stick to the sides.
- After test operation, make sure to clean the water filter with the shutoff valve closed.
- * Remove the water filter using H-6, and clean the filter.
- * Make sure to open the shutoff valve after cleaning the filter.

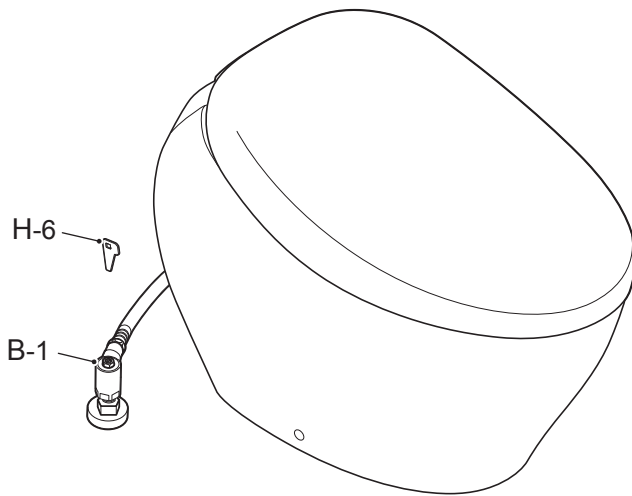

- Make sure that there are no scratches or other damage on the ceramic surface. If the ceramic surface is tightly pressed or rubbed against metals (watchbands, belt buckles, etc.), black or silver streak marks may be left on the surface.
- After installation, unseen dirt (oil or adhesive for piping) may remain in the toilet bowl. Be sure to wipe it off using a non-abrasive neutral detergent for toilets. Otherwise, the toilet bowl surface may not flush completely clean.
- After test operation, confirm that no water is leaking from any connection components. Improper installation could result in leaks that may damage property, such as household belongings.

MEMO

For installers

- Fill in the necessary information on the warranty card and be sure to hand it to the customer.
- Please explain the features and operation of the product to the customer.
- If the product will not be used for a long time (like when it is installed in an unoccupied, newly constructed building),
 - Turn off power at the breaker on the distribution board or disconnect the power plug.
 - To avoid leakage, remove the batteries from the remote control.